

GOLD SERIES | PUMP LESS VOLUTE KITS | SUBMITTAL

File No: 10.56
 Date: OCTOBER 26, 2015
 Supersedes: 10.56
 Date: SEPTEMBER 16, 2015

Job: _____ Representative: _____
 _____ Order no.: _____ Date: _____
 Engineer: _____ Submitted by: _____ Date: _____
 Contractor: _____ Approved by: _____ Date: _____

MODEL DATA

PLV				MOTOR		IMPELLER	QUANTITY REQUIRED	PROJECT IDENTIFICATION
SLEEVE BEARING CONFIG.		BALL BEARING CONFIG.		HP	VOLTAGE	inch (mm)		
ITEM #	MODEL	ITEM #	MODEL					
110116-200	S25 LV	110116MF-200	S25 LV/MF	1/12	115 VAC, 1 phase	2.75 (70)		
110116-201	H32 LV	110116MF-201	H32 LV/MF	1/6		3.38 (86)		
110116-202	H41 LV	110116MF-202	H41 LV/MF	1/6		4.25 (108)		
110116-203	S45 LV	110116MF-203	S45 LV/MF	1/4		4.25 (108)		
110116-204	S46 LV	110116MF-204	S46 LV/MF	1/3		4.25 (108)		
110116-300	H51 LV	110116MF-300	H51 LV/MF	1/4		5.25 (135)		
110116-301	H52 LV	110116MF-301	H52 LV/MF	1/3		5.25 (135)		
110116-302	H53 LV	110116MF-302	H53 LV/MF	1/2	115/230 VAC, 1 phase	5.25 (135)		
110116-304	H54 LV	110116MF-304	H54 LV/MF	3/4		5.25 (135)		
110116-306	S55 LV	110116MF-306	S55 LV/MF	1/2		5.25 (135)		
110116-303	H53-3 LV	110116MF-303	H53-3 LV/MF	1/2	208-230/460 VAC, 3 phase	5.25 (135)		
110116-305	H54-3 LV	110116MF-305	H54-3 LV/MF	3/4		5.25 (135)		
110116-307	S55-3 LV	110116MF-307	S55-3 LV/MF	1/2		5.25 (135)		
110108-675	Raypak 1	110108MF-675	Raypak 1/MF	1/3	115 VAC, 1 phase	4.38 (112)		
110108-677	Raypak 2	110108MF-677	Raypak 2/MF	1/2	115/230 VAC, 1 phase	4.50 (115)		
110108-717	Raypak 3	110108MF-717	Raypak 3/MF	3/4		4.50 (115)		
110108-680	Raypak 4	110108MF-680	Raypak 4/MF	1/2		No impeller		

MATERIALS OF CONSTRUCTION

Pump body: Gold painted steel, radially split for servicing ease

Motor: Maintenance-free, permanently lubricated

Sealed bearing assembly: Armstrong SBA with universal bearing module

- Stainless steel face plate
- Alloy steel shaft (heat treated for long life)
- **Maintenance free:** Ball bearing
- **Sleeve bearing:** Copper sleeve
Circular oil wick

Coupler: 4-spring or flexible coupler

Shaft: Alloy steel (heat treated for long life), copper sleeve

Mechanical seal: Carbon/SiC, stainless steel trim, Viton seal

Impeller: Noryl (registered trade mark of SABIC)

MAXIMUM PUMP OPERATING CONDITIONS

125 psig at 225°F (863 kPa at 107°C)

APPLICATION

Armstrong Gold series - Pump Less Volute kits enable service contractors and building maintenance technicians to replace circulators faster, reduce cost, and avoid waste. You get a complete unit, compatible with Armstrong circulators and those manufactured by others, that is already 'Less Volute'. Gold Series models are suitable for both cast iron (hydronic) and bronze (domestic water) applications.

PLV KIT	A	B	C	D	E	F	G
S25 LV	6.12 (155)	2.75 (70)	12.62 (321)	3.88 (98)	1.25 (31)	1.25 (33)	3.38 (86)
H32 LV	7.50 (190)	3.38 (86)	13.88 (354)	3.38 (84)	1.38 (36)	1.75 (44)	4.25 (107)
H41 LV	7.50 (190)	4.25 (108)	14.12 (358)	3.38 (84)	1.25 (32)	1.75 (44)	5.38 (135)
S45 LV	7.50 (190)	4.25 (108)	14.25 (360)	3.38 (84)	2.00 (50)	1.75 (45)	5.38 (135)
S46 LV	7.50 (190)	5.25 (135)	14.25 (360)	3.38 (84)	2.00 (50)	1.75 (45)	5.38 (135)
H51 LV	7.50 (190)	5.25 (135)	15.62 (396)	4.62 (117)	2.12 (53)	1.75 (43)	6.88 (173)
H52 LV	7.50 (190)	5.25 (135)	15.62 (396)	4.62 (117)	2.12 (53)	1.75 (43)	6.88 (173)
H53 LV	5.12 (130)	5.25 (135)	13.12 (333)	4.62 (117)	2.12 (53)	1.75 (43)	6.88 (173)
H54 LV	10.38 (235)	5.25 (135)	17.75 (452)	4.62 (117)	2.12 (53)	2.12 (54)	6.88 (173)
S55 LV	8.25 (210)	5.25 (135)	16.75 (426)	4.62 (117)	2.12 (53)	2.12 (54)	6.88 (173)
Raypak 1	7.50 (190)	4.38 (112)	14.75 (375)	4.62 (117)	2.12 (53)	2.12 (54)	6.88 (173)
Raypak 2	9.88 (251)	4.50 (115)	17.25 (439)	4.62 (117)	2.12 (53)	2.12 (54)	6.88 (173)
Raypak 3	10.38 (235)	4.50 (115)	17.75 (452)	4.62 (117)	2.12 (53)	2.12 (54)	6.88 (173)
Raypak 4	9.25 (235)	N/A	N/A	4.62 (117)	N/A	N/A	N/A

Dimensions shown are for reference only.
*All single phase motors are equipped with built-in thermal overload protection.
Three phase motors require external overload protection.

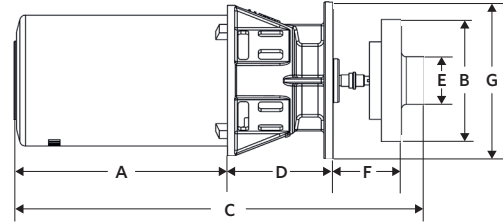

PERFORMANCE CURVE

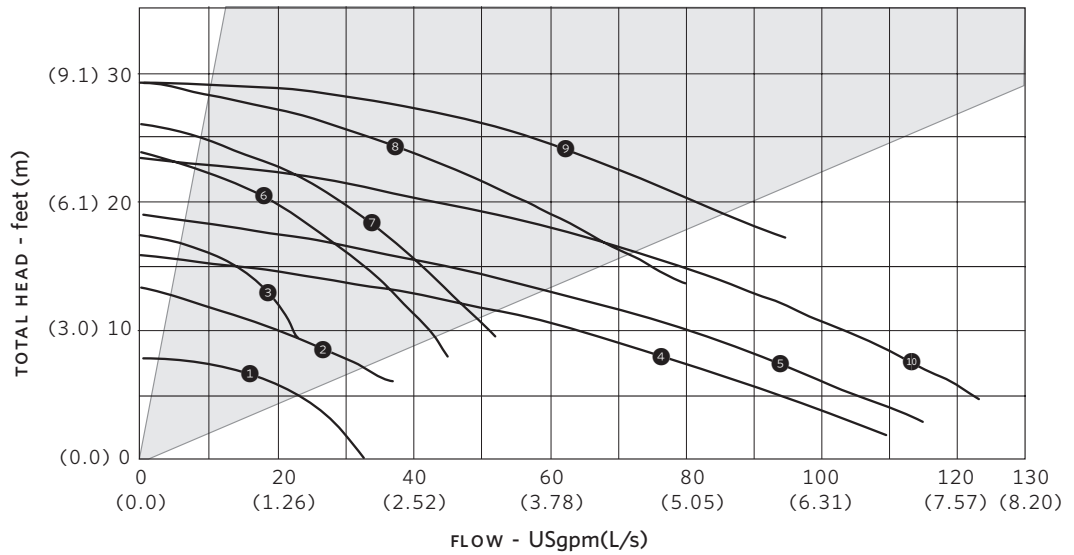

TORONTO
+1 416 755 2291

BUFFALO
+1 716 693 8813

BIRMINGHAM
+44 (0) 8444 145 145

MANCHESTER
+44 (0) 8444 145 145

BANGALORE
+91 (0) 80 4906 3555

SHANGHAI
+86 21 3756 6696

- ① S25
- ② H32
- ③ H41
- ④ S45
- ⑤ S46
- ⑥ H51
- ⑦ H52
- ⑧ H53
- ⑨ H54
- ⑩ S55