

## NON-ASME | DIAPHRAGM EXPANSION TANKS | SUBMITTAL

File No: 37.58  
 Date: APRIL 18, 2016  
 Supersedes: 11.590  
 Date: AUGUST 18, 2012

Job: \_\_\_\_\_ Representative: \_\_\_\_\_  
 \_\_\_\_\_ Ordered by: \_\_\_\_\_ Date: \_\_\_\_\_  
 Engineer: \_\_\_\_\_ Submitted by: \_\_\_\_\_ Date: \_\_\_\_\_  
 Contractor: \_\_\_\_\_ Approved by: \_\_\_\_\_ Date: \_\_\_\_\_

### APPLICATION

Armstrong expansion tanks provide storage in hydronic systems for increased fluid volume due to temperature change and expansion/contraction, while maintaining normal system charge pressure. This helps to avoid nuisance pressure relief equipment activation and unnecessary water make-up.

The double-clamped diaphragm maintains a vital and permanent pressurized air cushion, preventing expansion tank water-logging and air absorption into the hydronic system, as required for optimum trouble-free system performance.

### MATERIALS OF CONSTRUCTION

**Shell process connection:** Carbon steel/NPT - male

**Shell finish:** Enamel

**Diaphragm:** Butyl (double clamped)

**Charge connection:** Schrader (standard tire) valve

### INSTALLATION

Suspended models (Design 1) may be hung directly from Armstrong ART series Air Removal Traps, connected to adequately supported piping. All other models (Design 2 and 3) are free standing. Multiple tanks may be used for increased capacity requirements.

### TECHNICAL DATA

**Liquid type:** Conditioned water, optionally with up to 50% propyl or ethyl glycol solution

**Liquid temperature:** 20 to 240°F (-5 to 120°C)  
 non-freezing/non-boiling

**Maximum working pressure:** 100 psi (700 kPa, 7 Bar)

**Factory pre-charge:** 12 psi (83 kPa, 0.8 Bar), field adjustable

DESIGN 1

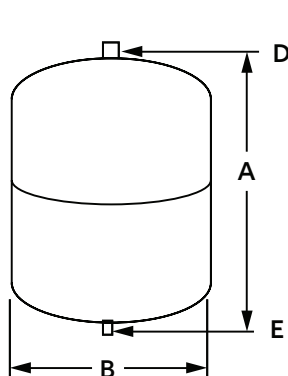

DESIGN 2

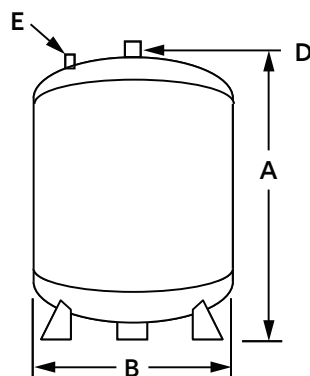

DESIGN 3

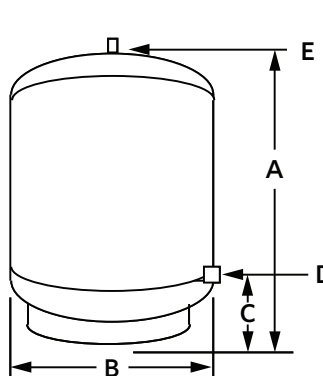

- A: Height
- B: Diameter
- C: Process connection location
- D: Process connection size
- E: Charge connection location

## DIMENSIONS

MODEL	DESIGN	VOLUME - USgpm (L)		DIMENSIONS - INCHES (MM)					WEIGHT
		TANK	ACCEPTANCE	A	B	C	D	E	Lbs (kg)
15	1	2.1 (8)	1.0 (4)	10.80 (274)	7.90 (201)	TDC	½"	BDC	5 (2)
30	1	4.8 (18)	3.0 (11)	13.70 (348)	10.60 (269)	TDC	½"	BDC	9 (4)
60	1	6.3 (24)	3.9 (15)	15.40 (391)	11.80 (300)	TDC	½"	BDC	14 (6)
90	1	13.2 (50)	8.2 (31)	21.10 (536)	15.00 (381)	TDC	½"	BDC	23 (10)
SX-30V	2	15.8 (60)	10.4 (39)	28.70 (729)	15.00 (381)	TDC	1"	TOP	31 (14)
SX-40V	3	21.2 (80)	13.1 (50)	23.60 (599)	17.70 (450)	7.75 (197)	1"	TDC	33 (15)
SX-60V	3	39.7 (150)	24.8 (94)	35.20 (894)	19.70 (500)	8.00 (203)	1"	TDC	60 (27)
SX-90V	3	52.9 (200)	32.8 (124)	33.90 (861)	23.60 (599)	9.00 (229)	1"	TDC	81 (37)
SX-110V	3	66.1 (250)	41.0 (155)	39.20 (996)	24.80 (630)	9.50 (241)	1"	TDC	90 (41)
SX-160V	3	79.4 (301)	49.2 (186)	44.70 (1135)	24.80 (630)	9.50 (241)	1"	TDC	106 (48)

## TORONTO

+1 416 755 2291

## BUFFALO

+1 716 693 8813

## BIRMINGHAM

+44 (0) 8444 145 145

## MANCHESTER

+44 (0) 8444 145 145

## BANGALORE

+91 (0) 80 4906 3555

## SHANGHAI

+86 21 3756 6696

## SÃO PAULO

+55 11 4781 5500