

PT Port and Extensions

SUBMITTAL

JOB: _____	REPRESENTATIVE: _____
_____	_____
ENGINEER: _____	ORDER NO: _____ DATE: _____
CONTRACTOR: _____	SUBMITTED BY: _____ DATE: _____
_____	APPROVED BY: _____ DATE: _____

Quantity	TAG No.	Model No.	Comments

PT PORTS & EXTENSIONS

Armstrong PT Ports enable the quick connection of pressure and temperature measuring instruments for testing, balancing, and troubleshooting hydronic systems. The dual EPDM seals provide superior protection against leaks in either heated or chilled water systems, and are compatible with water and ethylene or propylene glycol anti-freeze solutions. The 1/4" NPT male mounting thread mates with common pipe fittings and the 1/8" flared thread port mates with compatible instrument probes such as those used with an Armstrong DPM differential pressure manometer. Two sizes of 1/4" NPT M x F extensions are available to improve the accessibility of PT Ports that are mounted in hard-to-reach locations or where pipe insulation is used.

TECHNICAL DATA	
Maximum Operating Pressure	2068 kPa (300 psi) PN20 (20 bar)
Operating Temperature Range	-20°C to 150°C (-4°F to 300°F)

MATERIALS OF CONSTRUCTION	
Body and Cap	Brass ASTM B-16 H02 C36000
Seal	EPDM

DIMENSIONS and WEIGHTS					
	Item No.	A	B	C	Weight
PT Port	570148-003	13 (0.5)	39 (1.54)	1/4" NPT	28 (1.0)
PT Port Extension	570148-300	13 (0.5)	44 (1.75)	1/4" NPT	34 (1.2)
	570148-301	13 (0.5)	70 (2.75)	1/4" NPT	58 (2.0)

Note: All dimensions are in mm (inches) and weights are in g (oz.)

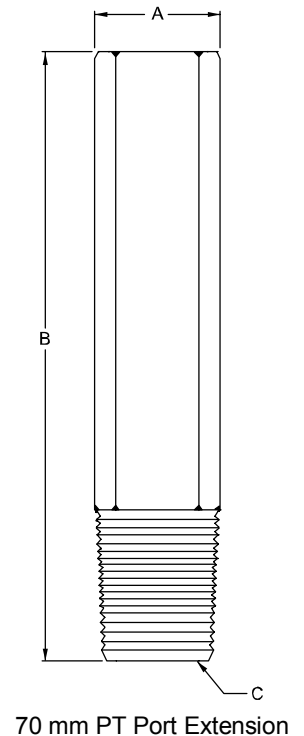
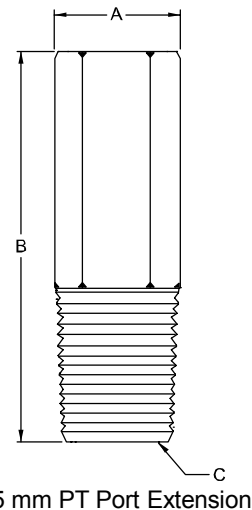
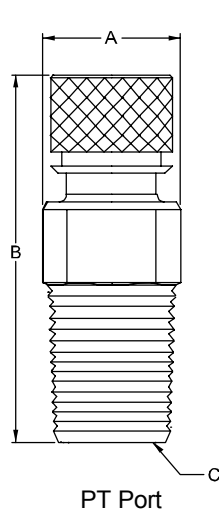

S. A. Armstrong Limited
 23 Bertrand Avenue
 Toronto, Ontario
 Canada, M1L 2P3
 T: (416) 755-2291
 F (Main): (416) 759-9101

Armstrong Pumps Inc.
 93 East Avenue
 North Tonawanda, New York
 U.S.A. 14120-6594
 T: (716) 693-8813
 F: (716) 693-8970

Armstrong Holden Brooke Pullen
 Wenlock Way
 Manchester
 United Kingdom, M12 5JL
 T: +44 (0) 1612 232223
 F: +44 (0) 1612 209660



© S.A. Armstrong Limited 2005