

## Series 4030 End Suction Base Mounted

# 1.5 x 1 x 8

# SUBMITTAL

|                   |                                 |
|-------------------|---------------------------------|
| JOB: _____        | REPRESENTATIVE: _____           |
| ENGINEER: _____   | ORDER NO: _____ DATE: _____     |
| CONTRACTOR: _____ | SUBMITTED BY: _____ DATE: _____ |
|                   | APPROVED BY: _____ DATE: _____  |

| PUMP DESIGN DATA                  |                               |
|-----------------------------------|-------------------------------|
| NO. OF PUMPS:                     | TAG:                          |
| CAPACITY: m <sup>3</sup> /h (L/s) | HEAD: m (ft)                  |
| LIQUID:                           | VISCOSITY:                    |
| TEMPERATURE: °C (°F)              | SPECIFIC GRAVITY:             |
| SUCTION: 38 mm (1.5") Flanged     | DISCHARGE: 25 mm (1") Flanged |

| MOTOR DESIGN DATA  |                                       |
|--|---------------------------------------|
| HP:  | RPM:                                  |
| FRAME SIZE:  | ENCLOSURE:                            |
| VOLTS:   | HERTZ: 50 Hz                          |
| EFFICIENCY*: <input type="checkbox"/> NEMA Premium (12.12) | <input type="checkbox"/> Other _____% |

\*Fractional power & Frame 56 motors are supplied with the standard efficiency of the manufacturer.

| MATERIALS OF CONSTRUCTION             |                                      |                             |                                      |                             |
|---------------------------------------|--------------------------------------|-----------------------------|--------------------------------------|-----------------------------|
| ANSI FLANGE RATING                    | <input type="checkbox"/> ANSI 125    |                             | <input type="checkbox"/> ANSI 250    |                             |
| CONSTRUCTION                          | <input type="checkbox"/> BF          | <input type="checkbox"/> AI | <input type="checkbox"/> BF          | <input type="checkbox"/> AI |
| IMPELLER                              | BRONZE                               | CAST IRON                   | BRONZE                               | CAST IRON                   |
| CASING                                | CAST IRON                            |                             | DUCTILE IRON                         |                             |
| GASKET                                | CONFINED NON-ASBESTOS FIBER          |                             |                                      |                             |
| BEARING FRAME                         | CAST IRON                            |                             |                                      |                             |
| ANTI-FRICTION BEARINGS                | PERMANENTLY LUBRICATED               |                             |                                      |                             |
| SHAFT                                 | CARBON STEEL                         |                             |                                      |                             |
| SHAFT SLEEVE                          | STAINLESS STEEL                      |                             |                                      |                             |
| COUPLER                               | WOODS SURE FLEX OR EQUAL             |                             |                                      |                             |
| COUPLER GUARD                         | STEEL OSHA                           |                             |                                      |                             |
| BASEPLATE                             | FABRICATED STEEL                     |                             |                                      |                             |
| <b>MAX. PUMP OPERATING CONDITIONS</b> | 12 bars at 66°C (175 psig at 150°F)  |                             | 20 bars at 65°C (300 psig at 150°F)  |                             |
|                                       | 10 bars at 121°C (140 psig at 250°F) |                             | 14 bars at 121°C (210 psig at 250°F) |                             |

- TOLERANCE OF ±3 mm (±0.125") SHOULD BE USED
- FOR EXACT INSTALLATION DATA PLEASE WRITE FACTORY FOR CERTIFIED DIMENSIONS
- SEE PERFORMANCE CURVES ON PAGE 2
- PUMP EQUIPPED WITH CASING DRAIN PLUG AND 1/4" NPT SUCTION AND DISCHARGE GAUGE PORTS

| MECHANICAL SEAL DESIGN DATA |                        |                          |
|-----------------------------|------------------------|--------------------------|
| FLUID TYPE                  | NON-POTABLE            | POTABLE (DRINKING) WATER |
| SEAL TYPE                   | 2A                     |                          |
| ROTATING FACE               | ANTIMONY LOADED CARBON | RESIN BONDED CARBON      |
| STATIONARY SEAT             | SILICON CARBIDE        |                          |
| SECONDARY SEAL              | VITON                  | EPDM                     |
| SPRING                      | STAINLESS STEEL        |                          |
| ROTATING HARDWARE           | STAINLESS STEEL        |                          |

### OPTIONAL EQUIPMENT

FOR PERFORMANCE CURVES SEE PAGE 2

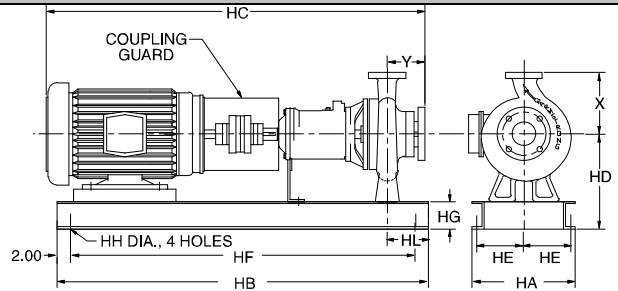

• DISCHARGE FLANGE IS SUPPLIED WITH DRILLED AND TAPPED BOTH HOLES

| MOTOR HORSEPOWER |          |      |          | MAX. DIMENSIONS mm (inches) |             |              |              |            |            |             |           |           |            |            | MAX. ASSEMBLY WEIGHT* |             |
|------------------|----------|------|----------|-----------------------------|-------------|--------------|--------------|------------|------------|-------------|-----------|-----------|------------|------------|-----------------------|-------------|
| ODP              |          | TEFC |          | FRAME                       | ODP / TEFC  |              |              |            |            |             |           |           |            |            |                       | kg (lbs.)   |
| 3000             | 1500     | 3000 | 1500     |                             | HA          | HB           | HC           | HD         | HE         | HF          | HG        | HH        | HL         | X          | Y                     |             |
| ---              | 0.5-0.75 | ---  | 0.5-0.75 | 56                          | 356 (14.00) | 762 (30.00)  | 671 (26.40)  | 235 (9.25) | 162 (6.38) | 660 (26.00) | 76 (3.00) | 19 (0.75) | 114 (4.50) | 165 (6.50) | 102 (4.00)            | 59.0 (130)  |
| ---              | 1        | ---  | 1        | 143T                        | 356 (14.00) | 762 (30.00)  | 713 (28.05)  | 235 (9.25) | 162 (6.38) | 660 (26.00) | 76 (3.00) | 19 (0.75) | 114 (4.50) | 165 (6.50) | 102 (4.00)            | 62.7 (138)  |
| 3                | 1.5      | ---  | 1.5      | 145T                        | 356 (14.00) | 762 (30.00)  | 713 (28.05)  | 235 (9.25) | 162 (6.38) | 660 (26.00) | 76 (3.00) | 19 (0.75) | 114 (4.50) | 165 (6.50) | 102 (4.00)            | 62.7 (138)  |
| 5                | ---      | 3    | ---      | 182T                        | 356 (14.00) | 762 (30.00)  | 781 (30.74)  | 235 (9.25) | 162 (6.38) | 660 (26.00) | 76 (3.00) | 19 (0.75) | 114 (4.50) | 165 (6.50) | 102 (4.00)            | 74.0 (163)  |
| 7.5              | ---      | 5    | ---      | 184T                        | 356 (14.00) | 762 (30.00)  | 781 (30.74)  | 235 (9.25) | 162 (6.38) | 660 (26.00) | 76 (3.00) | 19 (0.75) | 114 (4.50) | 165 (6.50) | 102 (4.00)            | 78.5 (173)  |
| 10               | ---      | 7.5  | ---      | 213T                        | 356 (14.00) | 838 (33.00)  | 874 (34.42)  | 235 (9.25) | 162 (6.38) | 737 (29.00) | 76 (3.00) | 19 (0.75) | 114 (4.50) | 165 (6.50) | 102 (4.00)            | 94.4 (208)  |
| 15               | ---      | 10   | ---      | 215T                        | 356 (14.00) | 838 (33.00)  | 874 (34.42)  | 235 (9.25) | 162 (6.38) | 737 (29.00) | 76 (3.00) | 19 (0.75) | 114 (4.50) | 165 (6.50) | 102 (4.00)            | 101.2 (223) |
| ---              | ---      | 15   | ---      | 254T                        | 406 (16.00) | 1016 (40.00) | 1026 (40.40) | 235 (9.25) | 187 (7.38) | 914 (36.00) | 76 (3.00) | 19 (0.75) | 114 (4.50) | 165 (6.50) | 102 (4.00)            | 133.0 (293) |

\*Assembly weight combines pump and motor.



# PERFORMANCE CURVES

Performance Guaranteed Only At Operating Point Indicated

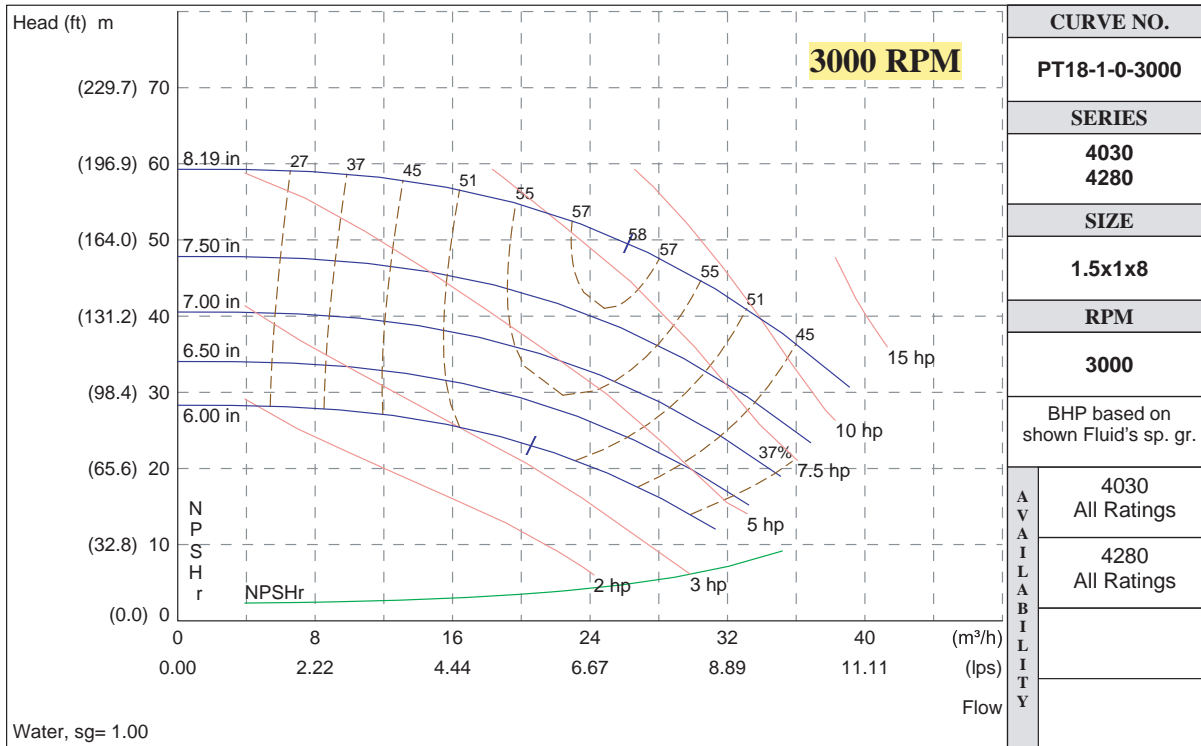

Water, sg= 1.00

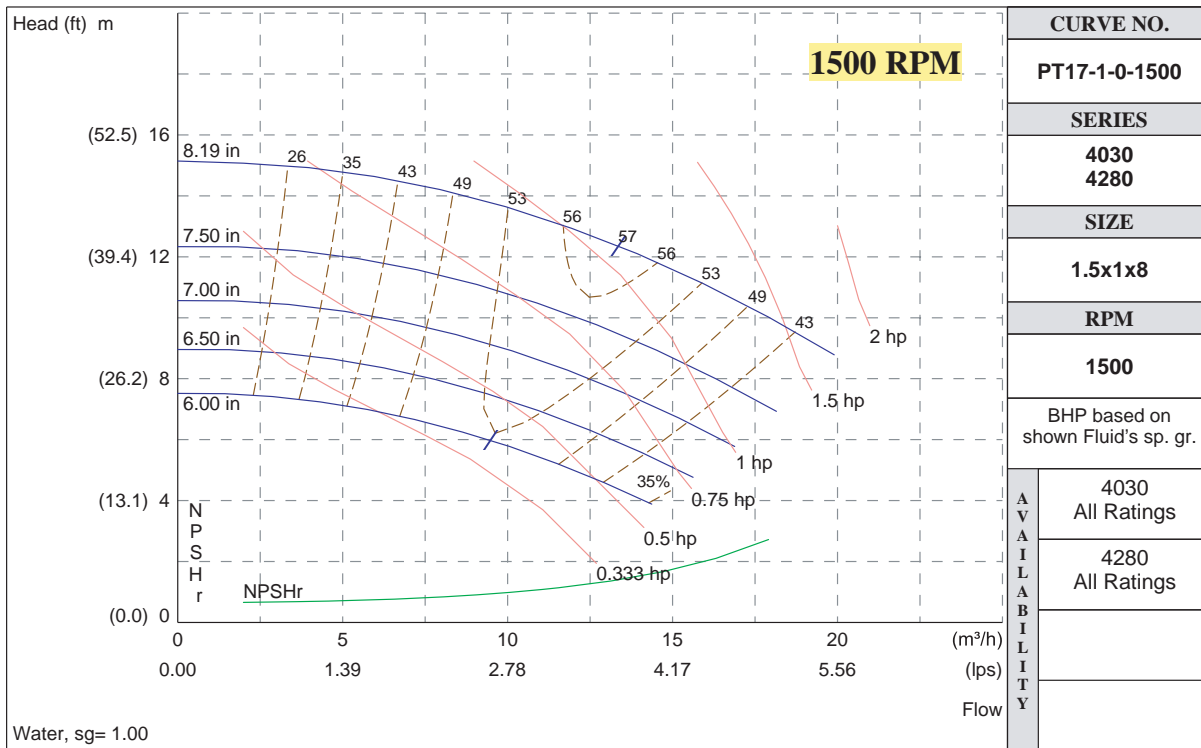

Water, sg= 1.00

Armstrong Integrated Limited  
 Wenlock Way  
 Manchester  
 United Kingdom, M12 5JL  
 T: +44 (0) 8444 145 145  
 F: +44 (0) 8444 145 146

S. A. Armstrong Limited  
 23 Bertrand Avenue  
 Toronto, Ontario  
 Canada, M1L 2P3  
 T: 416-755-2291  
 F: 416-759-9101



© S.A. Armstrong Limited 2011

For Armstrong locations worldwide, please visit [www.armstrongintegrated.com](http://www.armstrongintegrated.com)