



# MOTORIZED ZONE VALVES

## MODELS "AMZ"

FILE NO:	10.57
DATE:	June 30, 1994
SUPERSEDES:	NEW
DATE:	NEW

## SUBMITTAL

JOB: _____	REPRESENTATIVE: _____
_____	_____
_____	_____
ENGINEER: _____	ORDER NO: _____ DATE: _____
CONTRACTOR: _____	SUBMITTED BY: _____ DATE: _____
	APPROVED BY: _____ DATE: _____

**DESCRIPTION:**  
 A motorized zone valve designed for zoning hydronic heating and cooling systems. Use for coil units, bypass service.

MAXIMUM WORKING PRESSURE:	200 PSI (1380 kPa)
MAXIMUM OPERATING TEMPERATURE:	200°F (93°C)

OPTIONAL EQUIPMENT

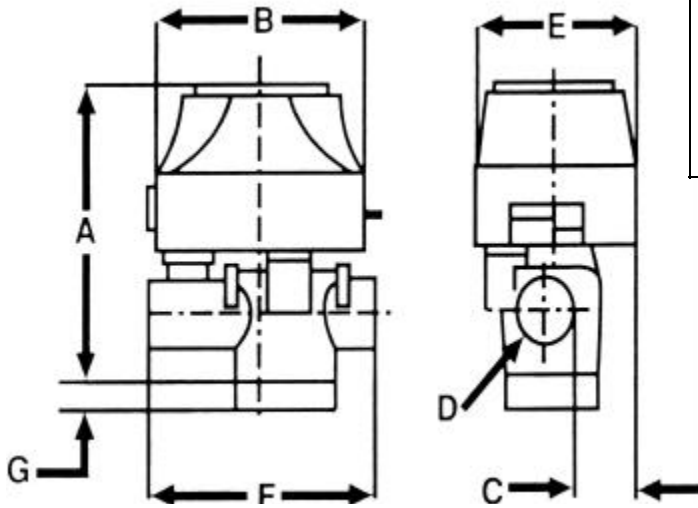

Valve Body: Forged brass  
 Valve rubber components: Buna 'N' paddle, Viton 'O' rings

Model	Conn. Size	Cv	Max. W.P.	Temp. Range	Electrical Rating	A	B	C	D	E	F	G
AMZ-50	1/2" Swt.	2.4	200PSI	40-225	24V 50/60 Hz (6.5 watts) 0.32amp.	4-1/8"	3-1/4"	1"	1"	2-5/8"	39/16"	x
AMZ-75	3/4" Swt.	2.4	200PSI	40-225	24V 50/60 Hz (6.5 watts) 0.32amp.	4-1/8"	3-1/4"	1"	1"	2-5/8"	39/16"	x
AMZI	1/2-1"	2.4	200PSI	40-225	24V 50/60 Hz (6.5 watts) 0.32amp.	4-1/8"	3-1/4"	1"	1"	2-5/8"	39/16"	x
Two-Way	Swt.											
			200PSI	40-225	24V 50/60 Hz (6.5 watts) 0.32amp.	4-1/8"	3-1/4"	1"	1"	2-5/8"	39/16"	7/16
Three-Way	Swt.	<b>Dimensions shown are for reference only.</b>										

**Electrical Wiring:** 18" Wire leads are provided with valves that are supplied with an end switch.

**Pressure Limits:** Maximum system pressure 200 PSI. 5/16" (AMZ-50-75. AMZI two-way) Port 25 PSI opening or closing pressure differential. 7/16" (AMZI three-way) port 10 PSI opening or closing pressure differential.

## INVERTED FLARE FITTINGS

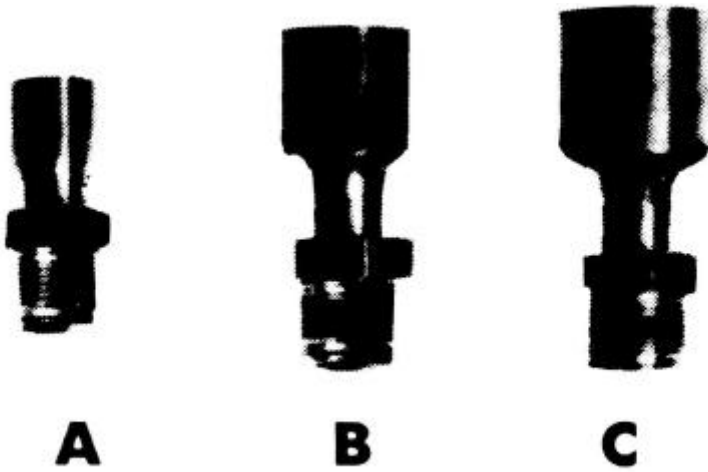

Inverted flare fittings are required on all AMZI series valves. Two fittings are needed on all two-way valves and three on all three-way valves

- |                        |   |
|------------------------|---|
| A. Part No, 272006:106 | 1/2" inverted flare nut and coupling assembly, female |
| B. Part No, 272006:107 | 3/4" inverted flare nut and coupling assembly, female |
| C. Part No, 272006:108 | 1" inverted flare nut and coupling assembly, female   |

### ADVANTAGES OF INVERTED FLARE CONSTRUCTION ARE:

1. The valve can be installed with no possibility of heat damage during the soldering operation.
2. The valve can easily be removed if necessary to clean the system or make any repairs.
3. The fittings can be silver soldered.
4. When used for replacement work, labour is saved because the old valve can be cut out rather than unsweated.

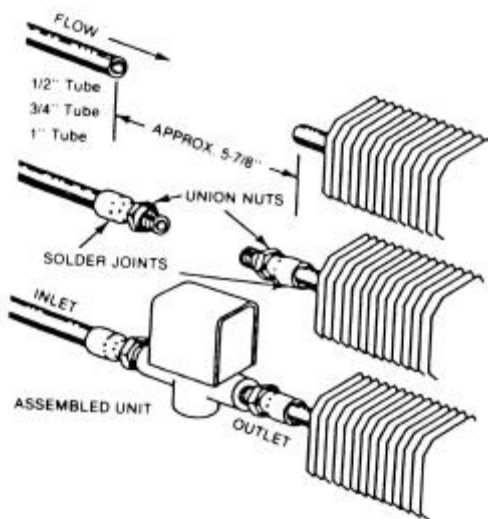

**AMZI valves are machined to accept the fittings shown. This type of connection eliminates the need for precision cut lengths of copper tube. Close quarter fittings make connection easy without tube benders or flaring tools.**

**S.A. Armstrong Limited**  
23 Bertrand Avenue  
Toronto, Ontario  
Canada, M1L 2P3  
Tel: (416) 755-2291  
Fax: (416) 759-9101

**Armstrong Pumps Limited**  
Peartree Road, Stanway  
Colchester, Essex  
United Kingdom, C03 5JX  
Tel: 01206-579491  
Fax: 01206-760532



**Armstrong Pumps Inc.**  
93 East Avenue  
Buffalo, New York  
U.S.A. 14120-6594  
Tel: (716) 693-8813  
Fax: (716) 693-8970

**Armstrong Darling Inc.**  
2200 Place Transcanadienne  
Montreal, Quebec  
Canada, H9P 2X5  
Tel: (514) 421-2424  
Fax: (514) 421-2436

