

PUMP SIZE	MOTOR KW	FLC AMPS 3x415V	PUMP WEIGHT KGS	SET WEIGHT KGS	VESSEL SIZE LITRES	WORKING PRESSURE BAR	TEST PRESSURE BAR
202T05T	0.55	1.43	1.75	1.85	60	10	15.0
203T05T	0.55	1.43	1.80	1.86	60	10	15.0
204T05T	0.55	1.43	1.90	1.88	60	10	15.0
205T07T	0.75	2.02	2.15	1.93	60	10	15.0
206T07T	0.75	2.02	2.20	1.94	60	10	15.0
207T11T	1.10	2.61	2.30	1.96	60	10	15.0
208T11T	1.10	2.61	2.35	1.97	60	10	15.0
209T11T	1.10	2.61	2.40	1.98	60	10	15.0
211T15T	1.50	3.45	3.10	2.12	20	15	22.5
212T15T	1.50	3.45	3.15	2.13	20	15	22.5

UNCONTROLLED

ALL FLANGES TO BS4504 16BAR

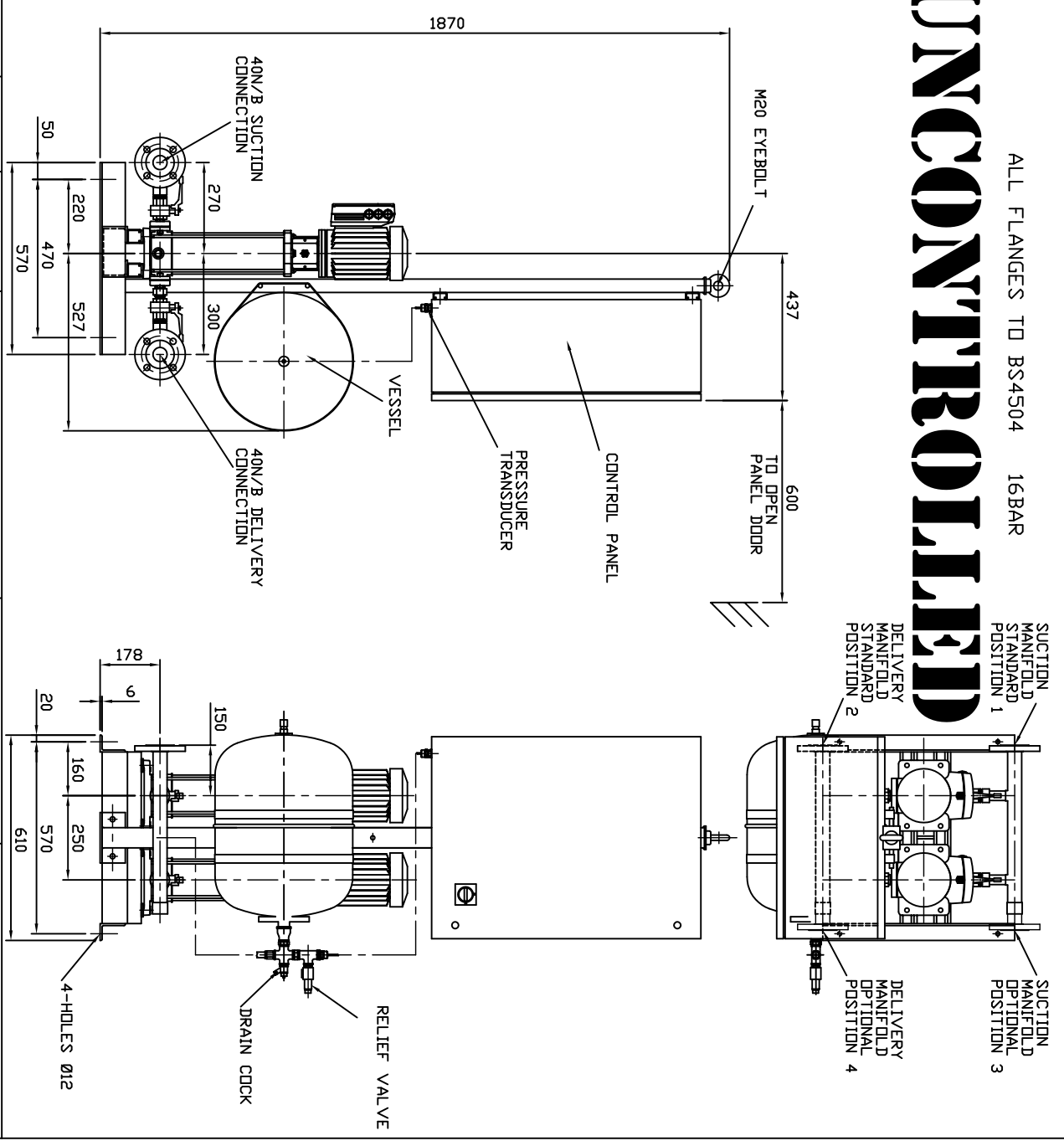

FLEXIBLE CONNECTORS OPTIONAL ONLY SUPPLIED WHEN ORDERED (<2-PER SET)

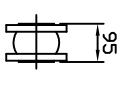

NOTE :-

- 1) MAIN POWER SUPPLY TO PANEL MUST BE SIZED TO COVER ALL PUMP RUNNING AT SAME TIME
- 2) LARGE STORAGE VESSELS IF ORDERED WILL BE SUPPLIED LOOSE FOR POSITIONING BY CLIENT TO SUIT THE AVAILABLE FLOOR SPACE. CLIENT IS TO PROVIDE A CONNECTION FROM THE VESSEL TO THE DELIVERY PIPEWORK ADJACENT TO THE SET ISOLATING AND DRAIN VALVES SHOULD BE FITTED

ANTI-VIBRATION MOUNTINGS OPTIONAL ONLY SUPPLIER WHEN ORDERED (<4-PER SET K2092/1)

ISSUE	DATE	BY	DRN	PJB
1	15/02/2006	CHK	PJB	APP

JOB No.	PART No.	WEIGHT KG	FILE NAME
-	-	-	Px10461-1
DESIGN No.	PATTERN No.	MATERIAL	MATL SPEC.
-	-	-	-

TITLE
GENERAL ARRANGEMENT
HYDROPAK IVSL2 SET
2-PUMP MODELS C/W
VLT8000 AQUA CONTROL

DRG No.	PX10461-1		
DATE	19/08/2004	DRN	BSD
CHK	EGJ	APP	EGJ
SCALE	NTS	SHEET	1 OF 1



VENLOCK WAY, MANCHESTER, M12 5JL
TEL: +44 (0) 161 223 2223