

PUMP SIZE	MOTOR KW	FLC AMPS	PUMP WEIGHT KGS	SET WEIGHT KGS	VESSEL SIZE LTRS	WORKING PRESSURE MAX BAR	TEST PRESSURE MAX BAR	STARTING CURRENT	L MM
SV3301	3	6.6	70	341	60	2.4	24	16	857
SV3302-2	4	8.5	78	357	60	3.4	24	20	936
SV3302-1	4	8.5	78	357	60	4	24	20	936

ITEM NO	DESCRIPTION	NO. OFF
1	BASE PLATE	1
2	BOLT - M12	12
3	WASHER - M12	12
4	CAGE NUT - M12	12
5	VMS PUMP	3
6	SUCTION/DISCHARGE MANIFOLD ASSY	2
7	ISOLATING VALVE 2 1/2"	6
8	NRV 2 1/2"	3
9	SUPPORT RIB	1
10	STANCHION	1
11	PRESSURE TRANSDUCER	1
12	PRESSURE GAUGE	1
13	FEMALE CROSS 1/2"	1
14	ISOLATING VALVE 1/2"	1
15	AIR VENT 1/4"	1
16	CONTROL PANEL	1
17	1/2" NIPPLE	3
18	1/2" x 1/4" REDUCING BUSH	3
19	BOLT - M10	9
20	WASHER - M10	9
21	NUT - M10	3
22	CAGE NUT - M10	6
23	1/2" T	1
24	END CAP	2
FASTENERS FOR PN16		
25	BOLT - M16	12
26	WASHER - M16	72
27	NUT - M16	60
28	STUD - M16x44	36
29	STUD - M16x59	12
FASTENERS FOR PN25		
25	BOLT - M16	24
26	WASHER - M16	144
27	NUT - M16	120
28	STUD - M16x54	72
29	STUD - M16x69	24
30	GASKET - 65NB	6
31	SPACER PIECE - 65NB	3

ANTI-VIBRATION MOUNTINGS OPTIONAL ONLY SUPPLIED WHEN ORDERED (4-PER SET K2092/10)

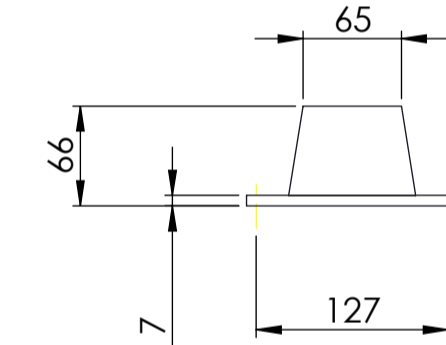
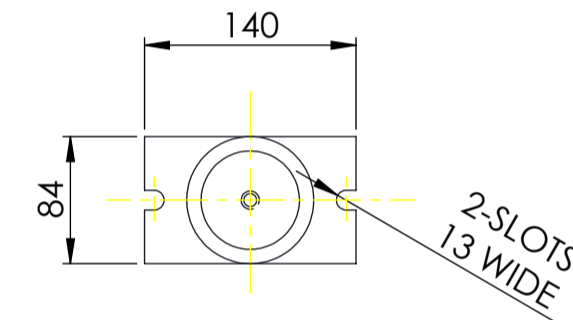

FLEXIBLE CONNECTORS OPTIONAL ONLY SUPPLIED WHEN ORDERED (2-PER SHEET)

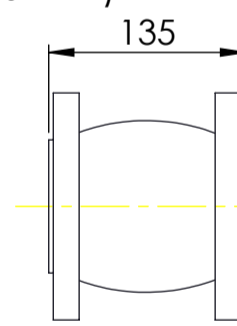

DETAIL A SCALE 1 : 4

NOTE:-

- 1) MAIN POWER SUPPLY TO PANEL MUST BE SIZED TO COVER ALL PUMPS RUNNING AT THE SAME TIME
- 2) LARGE STORAGE VESSELS, IF ORDERED, WILL BE SUPPLIED LOOSE FOR POSITIONING FOR CLIENT TO SUIT THE AVAILABLE FLOOR SPACE. CLIENT IS TO PROVIDE A CONNECTION FROM THE VESSEL TO THE DELIVERY PIPEWORK ADJACENT TO THE SET. ISOLATING AND DRAIN VALVES SHOULD BE FITTED IN THIS CONNECTION
- 3) 60 LT TANK WILL BE SUPPLIED LOOSE AND SHOULD BE ASSEMBLED ON SITE
- 4) FLANGES ARE AVAILABLE BOTH IN 16 & 25 BAR VERSION
- 5) FOR STANCHION SELECT DRAWING NO. PK14967

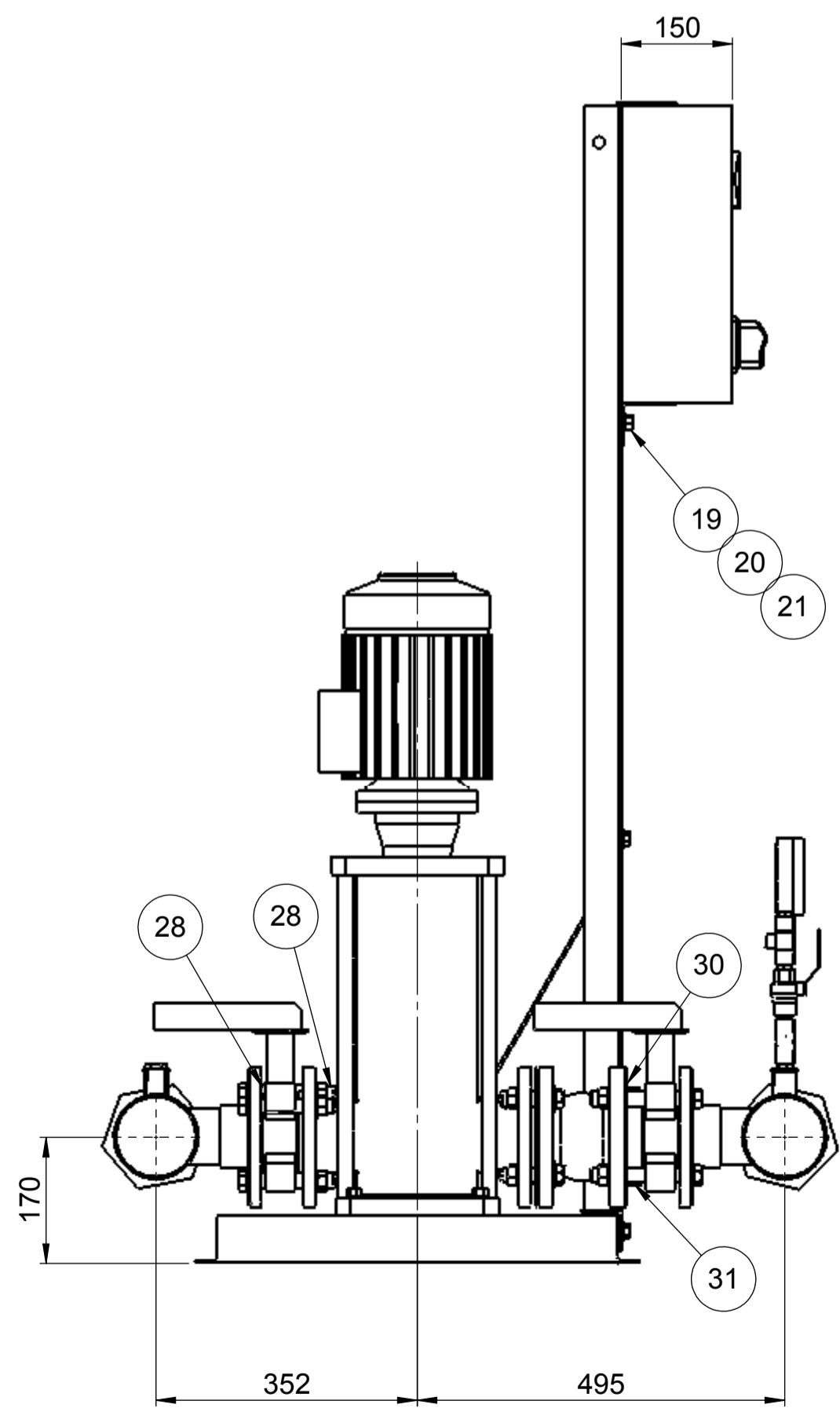
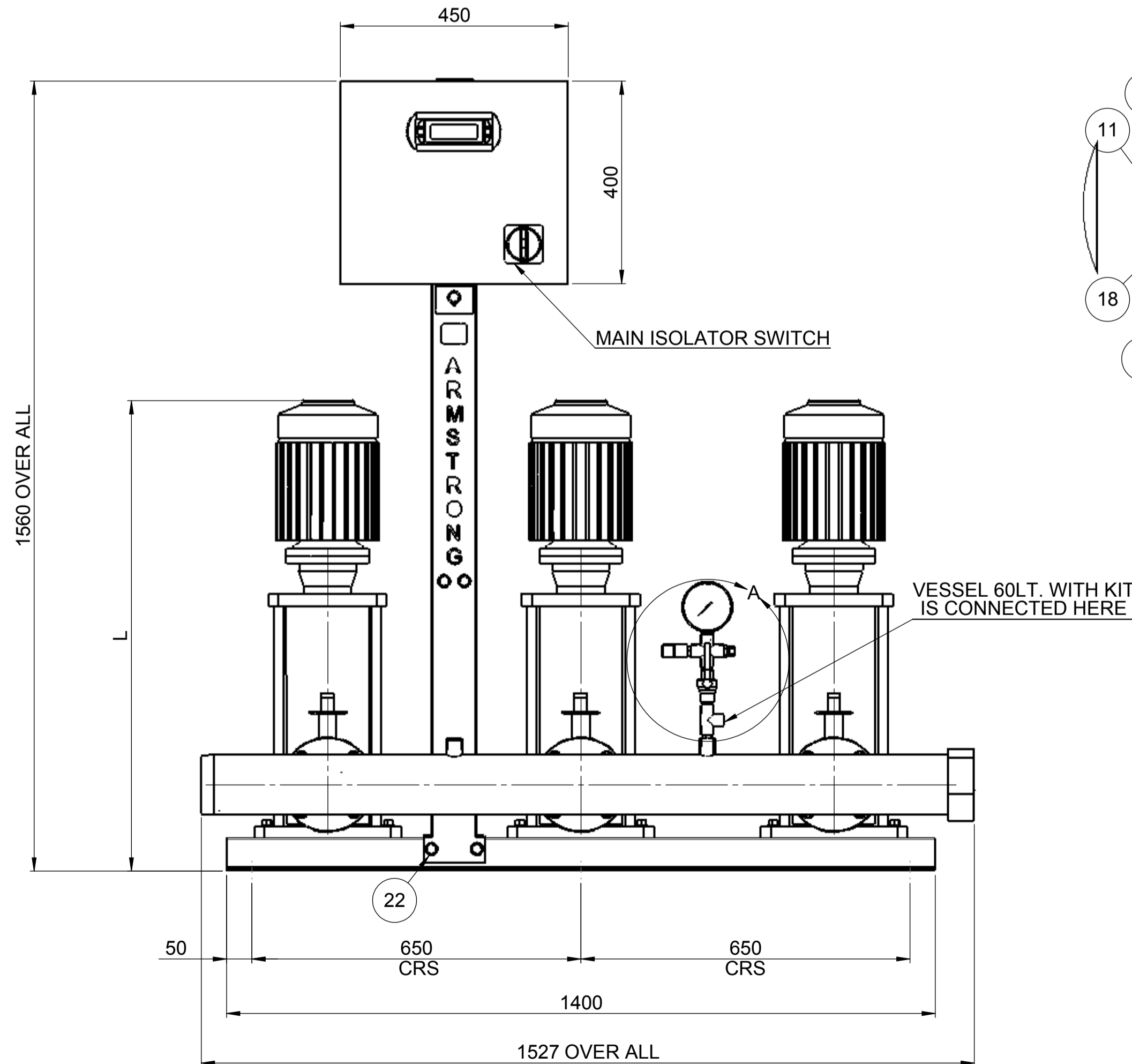

LAST MODIFICATION DETAILS				PROPRIETARY AND CONFIDENTIAL				UNLESS OTHERWISE SPECIFIED: DIMENSIONS ARE IN MM WELD SYMBOLS TO BS 499 SURFACE FINISH SHOWN IN UTM MACHINE WHERE SHOWN IN UTM TO TOLERANCE ± 0.3				DRAWN: PRAKASH CHECKED: Q.A. MFG APPR: ENG APPR: COMMENTS:				
REV:	DATE:	DRN BY:	CHECKED BY:	APP. BY:	THIS DRAWING IS THE PRIVATE AND CONFIDENTIAL PROPERTY OF ARMSTRONG. ALL COPYRIGHT, MANUFACTURING AND SALES RIGHTS RESERVED.				MATERIAL SPEC: BS 308				TITLE: 6800 HMP SERIES 3PUMP SV33			
DRAWING RELEASE LEVEL:								DO NOT SCALE				SIZE: A1				
SCALE: 1:8								WEIGHT: KG				SHEET 1 OF 1				



6800 HMP SERIES 3PUMP SV33

DRG. NO. PX10750

REV B