

File No.	6043.225
Date:	March 20, 2000
Supersedes:	6043.225
Date:	June 1, 1996

ARMSTRONG

PARTS LIST

SERIES 4385

EQUAL SUCTION & DISCHARGE

VERTICAL IN-LINE

PACKING GLAND DESIGN

"S" DESIGNATION

7/8" IMPELLER BORE -- 1 1/4" I.D. PACKING

OLD DESIGN

MODEL 4385 - VERTICAL PUMP - PACKING GLAND DESIGN

GROUP NUMBER SELECTION CHART

MOTOR FRAME	143-145 JP	182-184 JP	213-215 JP	254-256 JP	284-286 JP	324-326 JP	364-365 JP	364-365 TY	404-405 TY
PUMP SIZE	GROUP NO.								
1 1/2D	S	S	M	M					
2D	S	S	M	M					
3D	S	S	M	M	M	M			
4D	S	S	M	M	M	M			
1 1/2E	S	S	M	M	M	M			
2E	S	S	M	M	M	M			
3E	S	S	M	M	M	M			
4E	S	S	M	M	M	M			
6F			M	M	M	M			
6FN			M	M	M	M			
8F			M	M	M	M			
8FN			M	M	M	M			
6G					M	M	L		
6GN					M	M	L		
8G					M	M	L	L	L
8GN					M	M	L	L	L

4385 GROUP NO.	S	M	L
PACKING I.D. SIZE SHAFT SLEEVE O.D.	1 1/4"	1 3/4"	2 1/8"
IMPELLER BORE	7/8"	1 1/4"	1 3/4"

CLOSE COUPLED / MOTOR MOUNTED

OLD STYLE VERTICAL PACKING GLAND DESIGN

MODEL 4385

SECTIONAL DRAWING

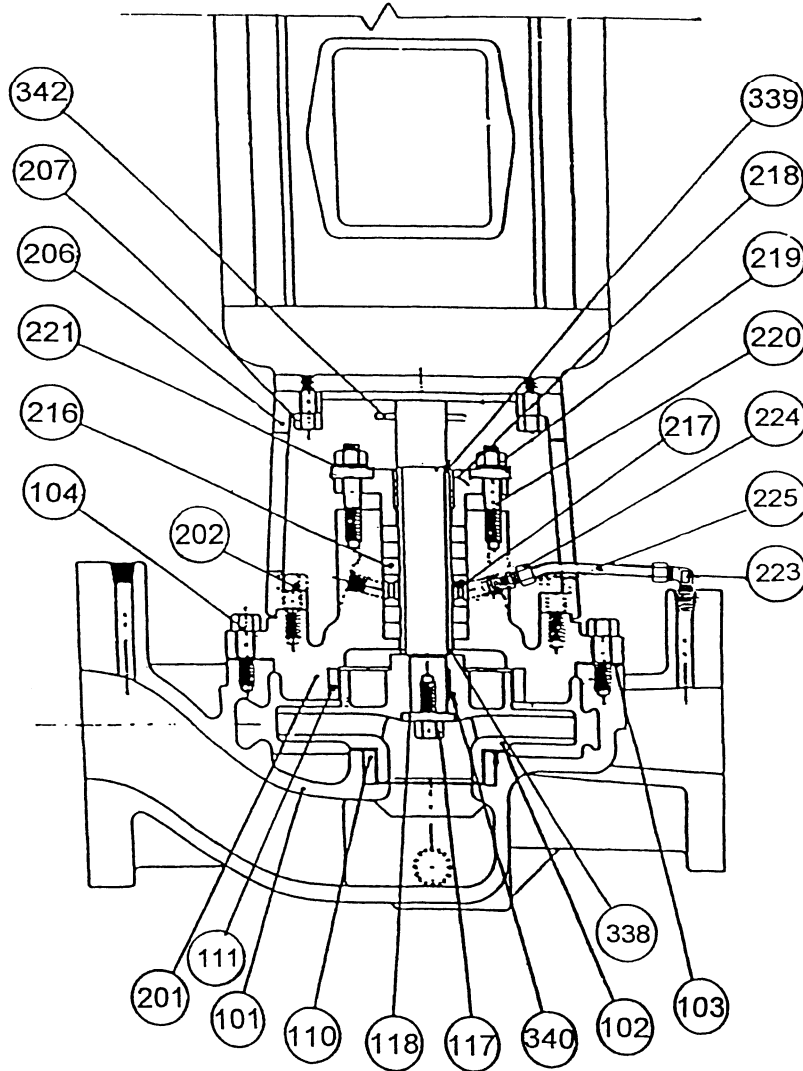

INDEX

ITEM NO.	DESCRIPTION	PAGE NO.	ITEM NO.	DESCRIPTION	PAGE NO.
101	VOLUTE	3, 4 & 5	218	GLAND PLATE	19, 20 & 21
102	IMPELLER	7, 8, 9 & 10	219	GLAND STUD NUT	19, 20 & 21
103	VOLUTE GASKET	6	220	GLAND STUD	19, 20 & 21
104	VOLUTE CAPSCREW & WASHER	26	221	GLAND STUD WASHER	19, 20 & 21
110	CASE WEAR RING (LOWER)	15 & 16	223	FLUSHLINE 90 DEG. ELBOW	27
111	WEAR RING (STUFFING BOX)	17 & 18	224	FLUSHLINE MALE CONNECTOR	27
117	IMPELLER CAPSCREW	19,20 & 21	225	FLUSHLINE TUBING	28
118	IMPELLER WASHER	19,20 & 21	338	SHAFT SLEEVE SPACER	22
201	STUFFING BOX COVER	11, 12 & 13	339	SHAFT SLEEVE	22
202	STUFF. BOX COVER CAPSCREW	25	340	IMPELLER KEY	19, 20 & 21
206	MOTOR/PUMP BRACKET	11, 12 & 13	342	WATER SLINGER	19, 20 & 21
207	MOTOR CAPSCREW	24	201/206	COMB. STUFF BOX & M/P BRKT.	14
216	GLAND PACKING	19, 20 & 21	not shown	SHAFT SLEEVE & SPACER KITS	23
217	LANTERN RING	19, 20 & 21			

CLOSE COUPLED / MOTOR MOUNTED PUMP PARTS

OLD STYLE VERTICAL PACKING GLAND DESIGN

MODEL 4385

ITEM 101 VOLUTE 125 LBS. A.S.A. FLANGES			
PUMP SIZE	MATERIAL	PART NUMBER	BAR CODE
1 1/2D	CAST IRON	425521-011	
1 1/2D	BRONZE	425521-041	
2D	CAST IRON	425523-011	
2D	BRONZE	425523-041	
3D	CAST IRON	425525-011	
3D	BRONZE	425525-041	
4D	CAST IRON	425527-011	
4D	BRONZE	425527-041	
1 1/2E	CAST IRON	425531-011	
1 1/2E	BRONZE	425531-041	
2E	CAST IRON	425533-011	
2E	BRONZE	425533-041	
3E	CAST IRON	425535-011	
3E	BRONZE	425535-041	
4E	CAST IRON	425537-011	
4E	BRONZE	425537-041	

VOLUTES CONTINUED ON PAGE 4

CLOSE COUPLED / MOTOR MOUNTED PUMP PARTS

OLD STYLE VERTICAL PACKING GLAND DESIGN

MODEL 4385

ITEM 101 VOLUTE 250 LBS. A.S.A. FLANGES			
PUMP SIZE	MATERIAL	PART NUMBER	BAR CODE
1 1/2D	CAST IRON	425522-011	
1 1/2D	BRONZE	425522-041	
2D	CAST IRON	425524-011	
2D	BRONZE	425524-041	
3D	CAST IRON	425526-011	
3D	BRONZE	425526-041	
4D	CAST IRON	425528-011	
4D	BRONZE	425528-041	
<hr/>			
1 1/2E	CAST IRON	425532-011	
1 1/2E	BRONZE	425532-041	
2E	CAST IRON	425534-011	
2E	BRONZE	425534-041	
3E	CAST IRON	425536-011	
3E	BRONZE	425536-041	
4E	CAST IRON	425538-011	
4E	BRONZE	425538-041	

CLOSE COUPLED / MOTOR MOUNTED PUMP PARTS

OLD STYLE VERTICAL PACKING GLAND DESIGN

MODEL 4385 "S" SIZE

ITEM 102 IMPELLER** 7/8" BORE

PUMP SIZE	MATERIAL	IMP. BORE	MAX. DIA.	PART NUMBER	BAR CODE
1 1/2 D	BRONZE	7/8"	7"	411860-041	
1 1/2 D	CAST IRON	7/8"	7"	411860-011	
2 D	BRONZE	7/8"	7"	411860-041	
2 D	CAST IRON	7/8"	7"	411860-011	
3 D	BRONZE	7/8"	7"	425529-041	
3 D	CAST IRON	7/8"	7"	425529-011	
4 D	BRONZE	7/8"	7"	411874-041	
4 D	CAST IRON	7/8"	7"	411874-011	
1 1/2 E	BRONZE	7/8"	9 1/2"	407922-041	
1 1/2 E	CAST IRON	7/8"	9 1/2"	407922-011	
2 E	BRONZE	7/8"	9 1/2"	411881-041	
2 E	CAST IRON	7/8"	9 1/2"	411881-011	
3 E	BRONZE	7/8"	9 1/2"	419465-041	
3 E	CAST IRON	7/8"	9 1/2"	419465-011	
4 E	BRONZE	7/8"	9 1/2"	425540-041	
4 E	CAST IRON	7/8"	9 1/2"	425540-011	

** Impeller Part Numbers are for full or maximum diameter Impellers. Always specify Pump Serial Number and where possible, measure and advise the diameter of the Impeller being replaced on these Pumps.

CLOSE COUPLED / MOTOR MOUNTED PUMP PARTS

OLD STYLE VERTICAL PACKING GLAND DESIGN

MODEL 4385 "S" SIZE

7/8" IMPELLER BORE---1 1/4" I.D. PACKING

ITEM 201 STUFFING BOX COVER					
PUMP SIZE	MOTOR FRAME SIZE	GROUP NO.	CONST.	PART NUMBER	BAR CODE
1 1/2D-4D	182-184YCZ	S	B.F. & A.I.	419457-011	
	143-145JP				
	182JP-184JP				
1 1/2D-4D	182C-184C	S	A.B.	419457-041	
	143JM-145JM				
	182JM-184JM				
1 1/2E-4E	182-184YCZ	S	B.F. & A.I.	419459-011	
	143-145JP				
	182JP-184JP				
1 1/2E-4E	182-184YCZ	S	A.B.	419459-041	
	143-145JP				
	182JP-184JP				

ITEM 206 MOTOR/PUMP BRACKET					
PUMP SIZE	MOTOR FRAME SIZE	GROUP NO.	CONST.	PART NUMBER	BAR CODE
1 1/2D-4D	182-184YCZ	S	ALL	425465-011	
	143-145JP				
	182JP-184JP				
1 1/2E-4E	182-184YCZ	S	ALL	425465-011	
	143-145JP				
	182JP-184JP				

NOTES:

- * B.F. Denotes "Bronze Fitted " construction. Parts in contact with pumped liquid are bronze or copper, except volute and cover plate.
- A.I. Denotes "All Iron " construction. Parts in contact with the pumped liquid are cast iron or steel, except shaft sleeve & mechanical seal.
- A.B. Denotes "All Bronze" construction. Parts in contact with the pumped liquid are bronze or stainless steel.

CLOSE COUPLED / MOTOR MOUNTED PUMP PARTS

OLD STYLE VERTICAL PACKING GLAND DESIGN

MODEL 4385

ITEM 110 CASE WEAR RING (LOWER)			
PUMP SIZE	CONST.	PART NUMBER	BAR CODE
1 1/2D	B.F. & A.B.	425550-041	
1 1/2D	A.I.	425550-071	
2D	B.F. & A.B.	425550-041	
2D	A.I.	425550-071	
3D	B.F. & A.B.	425550-045	
3D	A.I.	425550-075	
4D	B.F. & A.B.	425550-045	
4D	A.I.	425550-075	
1 1/2E	B.F. & A.B.	425550-041	
1 1/2E	A.I.	425550-071	
2E	B.F. & A.B.	425550-043	
2E	A.I.	425550-073	
3E	B.F. & A.B.	425550-045	
3E	A.I.	425550-075	
4E	B.F. & A.B.	425550-047	
4E	A.I.	425550-077	

NOTES:

* B.F. Denotes "Bronze Fitted " construction. Parts in contact with pumped liquid are bronze or copper, except volute and cover plate.

A.I. Denotes "All Iron " construction. Parts in contact with the pumped liquid are cast iron or steel, except shaft sleeve & mechanical seal.

A.B. Denotes "All Bronze" construction. Parts in contact with the pumped liquid are bronze or stainless steel.

CLOSE COUPLED / MOTOR MOUNTED PUMP PARTS

OLD STYLE VERTICAL PACKING GLAND DESIGN

MODEL 4385

ITEM 111 CASE WEAR RING (STUFFING BOX)

PUMP SIZE SIZE	CONST.	PART NUMBER	BAR CODE
1 1/2D	B.F. & A.B.	425550-049	
1 1/2D	A.I.	425550-079	
2D	B.F. & A.B.	425550-049	
2D	A.I.	425550-079	
3D	B.F. & A.B.	425550-049	
3D	A.I.	425550-079	
4D	B.F. & A.B.	425550-049	
4D	A.I.	425550-079	
1 1/2E	B.F. & A.B.	425550-051	
1 1/2E	A.I.	425550-081	
2E	B.F. & A.B.	425550-051	
2E	A.I.	425550-081	
3E	B.F. & A.B.	425550-051	
3E	A.I.	425550-081	
4E	B.F. & A.B.	425550-051	
4E	A.I.	425550-081	

NOTES:

- * B.F. Denotes "Bronze Fitted " construction. Parts in contact with pumped liquid are bronze or copper, except volute and cover plate.
- A.I. Denotes "All Iron " construction. Parts in contact with the pumped liquid are cast iron or steel, except shaft sleeve & mechanical seal.
- A.B. Denotes "All Bronze" construction. Parts in contact with the pumped liquid are bronze or stainless steel.

CASE WEAR RINGS (STUFFING BOX) CONTINUED ON PAGE 18

CLOSE COUPLED / MOTOR MOUNTED PUMP PARTS

OLD STYLE VERTICAL PACKING GLAND DESIGN

MODEL 4385 "S" SIZE

7/8" IMPELLER BORE---1 1/4" I.D. PACKING

COMMON PARTS			
ITEM NO.	DESCRIPTION	PART NUMBER	BAR CODE
117	IMPELLER CAPSCREW S/S	911900-108	
118	IMPELLER WASHER B.F./A.I./A.B.*	425742-001	
216	GLAND PACKING (5 RINGS REQ'D)	966301-002	
217	LANTERN RING B.F. & A.B.	419461-041	
217	LANTERN RING A.I.	419461-011	
218	GLAND B.F. & A.B.	419463-041	
218	GLAND A.I.	419463-011	
219	GLAND STUD (2 REQ'D) 3/8"NC X 2 3/8"S/S	915221-420	
220	GLAND NUT (2 REQ'D) 3/8"NC S/S	913121-400	
221	GLAND STUD WASHER (2 REQ'D) 3/8" S/S	927114-000	
340	IMPELLER KEY 3/16" SQ. X 1 1/4" LG.	428160-010	
342	WATER SLINGER	406622-000	

NOTES:

* B.F. Denotes "Bronze Fitted " construction. Parts in contact with pumped liquid are bronze or copper, except volute and cover plate.

A.I. Denotes "All Iron" construction. Parts in contact with the pumped liquid are cast iron or steel, except shaft sleeve & mechanical seal.

A.B. Denotes "All Bronze" construction. Parts in contact with the pumped liquid are bronze or stainless steel.

CLOSE COUPLED / MOTOR MOUNTED PUMP PARTS

OLD STYLE VERTICAL PACKING GLAND DESIGN

MODEL 4385 "S" Size

7/8" IMPELLER BORE---1 1/4" I.D. PACKING

ITEM 339 SHAFT SLEEVE

GROUP No.	SLEEVE O.D.	CONST.	PART NUMBER	BAR CODE
S	1 1/4"	A.B. - B.F.	425869-013	
S	1 1/4"	A.I.	425869-014	

SHAFT SLEEVE SPACER

GROUP NO.	SLEEVE O.D.	CONST.	PART NUMBER	BAR CODE
S	1 1/4"	A.B. - B.F. - A.I.	425868-001	

ITEM 103 VOLUTE GASKET

PUMP SIZE	CONST.	PART NUMBER	BAR CODE
1 1/2D TO 4D	ALL	106592-000	
1 1/2E TO 4E	ALL	406604-000	

NOTES:

- * B.F. Denotes "Bronze Fitted" construction. Parts in contact with pumped liquid are bronze or copper, except volute and cover plate.
- A.I. Denotes "All Iron" construction. Parts in contact with the pumped liquid are cast iron or steel, except shaft sleeve & mechanical seal.
- A.B. Denotes "All Bronze" construction. Parts in contact with the pumped liquid are bronze or stainless steel.

CLOSE COUPLED / MOTOR MOUNTED PUMP PARTS

OLD STYLE VERTICAL PACKING GLAND DESIGN

MODEL 4385 "S" SIZE

7/8" IMPELLER BORE---1 1/4" I.D. PACKING

SHAFT SLEEVE & SPACER KITS				
GROUP NO.	SLEEVE O.D.	CONST.	PART NUMBER	BAR CODE
S	1 1/4"	A.B. - B.F.	835085-003	
S	1 1/4"	A.I.	835085-004	

ITEM 207 MOTOR CAPSCREW				
MOTOR FRAME SIZE	CAPSCREW SIZE	NO. REQ'D	PART NUMBER	BAR CODE
182C-184C				
143JM-145JM	3/8-16NCX1"	4	911121-108	
182JM-184JM				

* B.F. Denotes "Bronze Fitted " construction. Parts in contact with pumped liquid are bronze or copper, except volute and cover plate.

A.I. Denotes "All Iron" construction. Parts in contact with the pumped liquid are cast iron or steel, except shaft sleeve & mechanical seal.

A.B. Denotes "All Bronze" construction. Parts in contact with the pumped liquid are bronze or stainless steel.

CLOSE COUPLED / MOTOR MOUNTED PUMP PARTS

OLD STYLE VERTICAL PACKING GLAND DESIGN

MODEL 4385

ITEM 202 MOTOR/PUMP BRACKET CAPSCREW

FRAME SIZE	PUMP SIZE	SIZE	NO. REQ'D	PART NUMBER	BAR CODE
143JP TO 184JP	1 1/4D TO 4D	3/8-16NCX1"	4	911121-108	

M/P BRACKET CAPSCREW LOCKWASHER

FRAME SIZE	PUMP SIZE	SIZE	NO. REQ'D	PART NUMBER	BAR CODE
143JP TO 184JP	1 1/4D TO 4D	3/8"	4	927211-100	

ITEM 104 VOLUTE CAPSCREW

FRAME SIZE	PUMP SIZE	SIZE	NO. REQ'D	PART NUMBER	BAR CODE
143JP TO 256JP	1 1/4D TO 4D	3/8-16NCX1"	8	911121-108	
143JP TO 326JP	1 1/2E TO 4E	3/8-16NCX1"	12	911121-108	

VOLUTE CAPSCREW LOCKWASHER

FRAME SIZE	PUMP SIZE	SIZE	NO. REQ'D	PART NUMBER	BAR CODE
143JP TO 326JP	1 1/4D TO 4D	7/16"	8	927212-100	
143JP TO 326JP	1 1/2E TO 4E	7/16"	12	927212-100	

CLOSE COUPLED / MOTOR MOUNTED PUMP PARTS

OLD STYLE VERTICAL PACKING GLAND DESIGN

MODEL 4385

ITEM 223 MALE ELBOW *						
PUMP SIZE	NO. REQ'D	MAT'L	SIZE	CONST.	PART NUMBER	BAR CODE
ALL	1	BRASS	3/8" TUBE X 1/4" NPT	B.F. & A.B.	939003-109	
ALL	1	STEEL	3/8" TUBE X 1/4" NPT	A.I.	939003-209	

ITEM 224 MALE CONNECTOR *						
PUMP SIZE	NO. REQ'D	MAT'L	SIZE	CONST.	PART NUMBER	BAR CODE
ALL	1	BRASS	3/8" TUBE X 1/4" NPT	B.F. & A.B.	939001-114	
ALL	1	STEEL	3/8" TUBE X 1/4" NPT	A.I.	939001-214	

NOTES:

* PUMPS ORIGINALLY SUPPLIED WITH 1/4" TUBING FLUSH LINES, WHEN REPLACING FLUSH LINES OR COMPONENTS CHANGE TUBING AND FITTINGS TO 3/8" PER ABOVE PARTS LIST.

** B.F. Denotes "Bronze Fitted " construction. Parts in contact with pumped liquid are bronze or copper, except volute and cover plate.
 A.I. Denotes "All Iron " construction. Parts in contact with the pumped liquid are cast iron or steel, except shaft sleeve & mechanical seal.
 A.B. Denotes "All Bronze" construction. Parts in contact with the pumped liquid are bronze or stainless steel.

CLOSE COUPLED / MOTOR MOUNTED PUMP PARTS

OLD STYLE VERTICAL PACKING GLAND DESIGN

MODEL 4385

ITEM 225 FLUSH LINE TUBING**						
PUMP SIZE	TUBING SIZE	NO. REQ'D	LENGTH	CONST.	PART NUMBER	BAR CODE
1 1/2D TO 4D				B.F. - A.B.	997531-004	
AND	3/8" OD	1	12"LG.			
1 1/2E TO 4E				A.I.	997153-004	

NOTES:

* B.F. Denotes "Bronze Fitted " construction. Parts in contact with pumped liquid are bronze or copper, except volute and cover plate.

A.I. Denotes "All Iron " construction. Parts in contact with the pumped liquid are cast iron or steel, except shaft sleeve & mechanical seal.

A.B. Denotes "All Bronze" construction. Parts in contact with the pumped liquid are bronze or stainless steel.

**** PUMPS ORIGINALLY SUPPLIED WITH 1/4" TUBING FLUSH LINES, WHEN REPLACING FLUSH LINES OR COMPONENTS CHANGE TUBING AND FITTINGS TO 3/8" PER ABOVE PARTS LIST.**