

ARMSTRONG

PARTS LIST

SERIES 4285

"CLOSE COUPLED"

OR

MOTOR MOUNTED PUMP

PACKING GLAND DESIGN

TANGENTIAL DISCHARGE

"M" DESIGNATION

1 1/4" IMPELLER BORE--1 5/8" SHAFT SLEEVE

OLD DESIGN

4285 POWER FRAMES, ALL SPEEDS, SIZE DESIGNATION

| SPEED | | MOTOR HP | | | | | | | | | | | |
|---------------|-------------|-----------|---------|-------|-------|--------|--------|--------|--------|--------|--------|--------|--------|
| 1800RPM | | 1/2,3/4&1 | 1 1/2&2 | 3 | 5 | 7 1/2 | 10 | 15 | 20 | 25 | 30 | 40 | 50 |
| 3600RPM | | 1 1/2 | 2&3 | 5 | 7 1/2 | 10 | 15 | 20 | 25 | 30 | 40 | 50 | 60 |
| FRAME SIZE | 1954 RERATE | 182C | 184C | 213C | 215C | 254UC | 256UC | 284UC | 286UC | 324UC | 326SC | | |
| | WEST COAST | 182YCZ | 184YCZ | 213CZ | 215CZ | 254UCZ | 256UCZ | 254UCZ | 256UCZ | 284UCZ | 286UCZ | 324UCZ | 326UCZ |
| | 1972 RERATE | 143JP | 145JP | 182JP | 184JP | 213JP | 215JP | 254JP | 256JP | 284JP | 286JP | 324JP | 326JP |
| PUMP SIZE | | | | | | | | | | | | | |
| 1 1/4D | | S | S | S | S | M | - | - | - | - | - | - | - |
| 1 1/2D | | S | S | S | S | M | M | - | - | - | - | - | - |
| 2D | | S | S | S | S | M | M | - | - | - | - | - | - |
| 2 1/2D | | S | S | S | S | M | M | M | - | - | - | - | - |
| 3D | | S | S | S | - | M | M | M | M | - | - | - | - |
| 4D | | - | S | S | S | - | M | M | M | M | M | - | - |
| 1 1/4E | | - | S | S | S | - | M | M | M | M | - | - | - |
| 1 1/2E | | - | S | S | S | - | M | M | M | M | M | - | - |
| 2E | | - | S | S | S | M | - | M | M | M | M | M | - |
| 2 1/2E | | - | - | S | S | M | - | - | - | - | - | - | - |
| 3E | | - | - | S | S | M | - | - | - | - | - | - | - |
| 4E | | - | - | S | S | M | M | M | - | - | - | - | - |
| 5E | | - | - | S | S | M | M | M | M | - | - | - | - |
| 6E | | - | - | - | - | - | | M | M | M | - | - | - |

"S" DESIGNATION - 7/8" IMPELLER BORE, 1 1/4" I.D. PACKING

"M" DESIGNATION - 1 1/4" IMPELLER BORE, 1 5/8" I.D. PACKING

CLOSE COUPLED / MOTOR MOUNTED

OLD STYLE TANGENTIAL, PACKING GLAND DESIGN

MODEL 4285 "M" DESIGNATION

SECTIONAL DRAWING

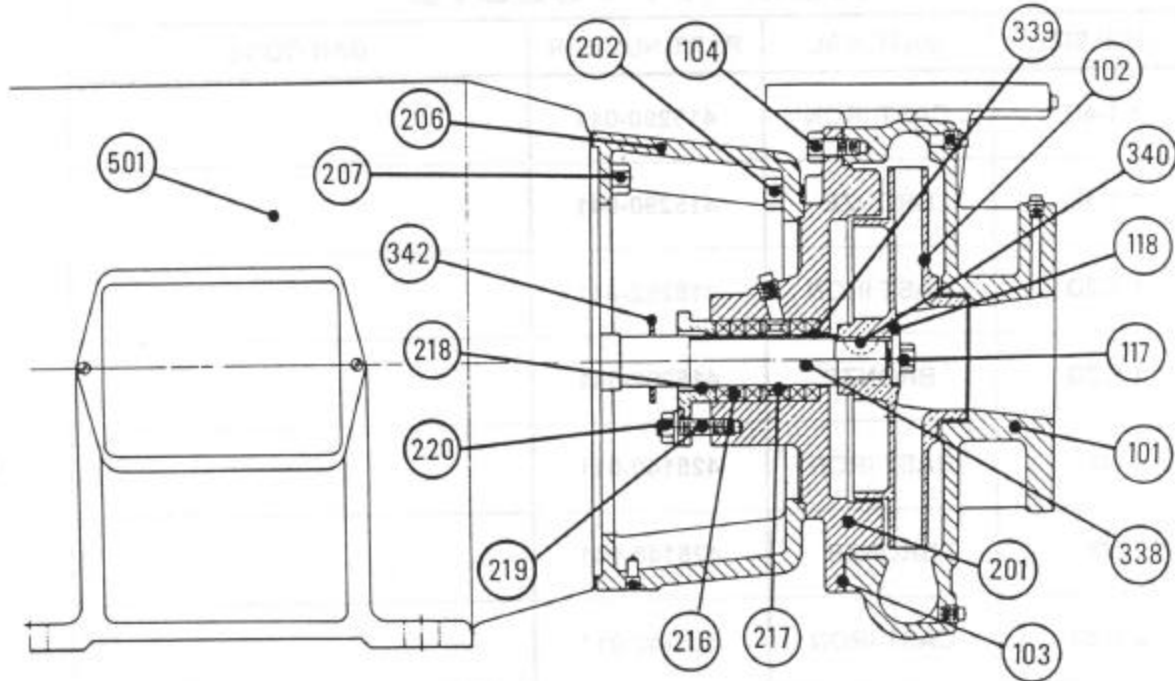

| ITEM NO. | DESCRIPTION | PAGE NO. | ITEM NO. | DESCRIPTION | PAGE NO. |
|----------|--------------------------|----------|-----------|----------------------------|----------|
| 101 | VOLUTE | 3 & 4 | 217 | LANTERN RING | 11 |
| 102 | IMPELLER | 5 & 6 | 218 | GLAND | 11 |
| 103 | VOLUTE GASKET | 7 | 219 | GLAND STUD | 11 |
| 104 | VOLUTE CAPSCREW & WASHER | 7 | 220 | GLAND STUD NUT | 11 |
| 117 | IMPELLER CAPSCREW | 11 | 222 | GLAND CLAMP | 11 |
| 118 | IMPELLER WASHER | 11 | 225 | M/P BRKT. CAPS. LOCKWASHER | 9 |
| 201 | COVERPLATE | 7 | 339 | SHAFT SLEEVE | 10 |
| 202 | COVERPLATE CAPSCREW | 9 | 340 | IMPELLER KEY | 11 |
| 206 | MOTOR/PUMP BRACKET | 8 | 342 | WATER SLINGER | 11 |
| 207 | MOTOR CAPSCREW | 8 | not shown | SHAFT SLEEVE SPACER | 10 |
| 216 | GLAND PACKING | 11 | not shown | SHAFT SLEEVE & SPACER KITS | 10 |

**MODEL 4285 "M" SIZE
CLOSE COUPLED / MOTOR MOUNTED
PUMP PARTS**

1 1/4" IMPELLER BORE---PACKING GLAND 1 5/8" O.D. SHAFT SLEEVE
"OLD STYLE TANGENTIAL"

| ITEM 101 VOLUTE | | | |
|------------------------|-----------|-------------|----------|
| PUMP SIZE | MATERIAL | PART NUMBER | BAR CODE |
| 1 1/4D | CAST IRON | 415290-011 | |
| 1 1/4D | BRONZE | 415290-041 | |
| 1 1/2D | CAST IRON | 415292-011 | |
| 1 1/2D | BRONZE | 415292-041 | |
| 2D | CAST IRON | 425140-011 | |
| 2D | BRONZE | 425140-041 | |
| 2 1/2D | CAST IRON | 425142-011 | |
| 2 1/2D | BRONZE | 425142-041 | |
| 3D | CAST IRON | 425144-011 | |
| 3D | BRONZE | 425144-041 | |
| 4D | CAST IRON | 415298-011 | |
| 4D | BRONZE | 415298-041 | |

**MODEL 4285 "M" SIZE
CLOSE COUPLED / MOTOR MOUNTED
PUMP PARTS**

1 1/4" IMPELLER BORE---PACKING GLAND 1 5/8" O.D. SHAFT SLEEVE
"OLD STYLE TANGENTIAL"

| ITEM 101 VOLUTE (cont'd) | | | |
|---------------------------------|-----------|-------------|----------|
| PUMP SIZE | MATERIAL | PART NUMBER | BAR CODE |
| 1 1/4E | CAST IRON | 416167-011 | |
| 1 1/4E | BRONZE | 416167-041 | |
| 1 1/2E | CAST IRON | 425146-011 | |
| 1 1/2E | BRONZE | 425146-041 | |
| 2E | CAST IRON | 419152-011 | |
| 2E | BRONZE | 419152-041 | |
| 2 1/2E | CAST IRON | 415296-011 | |
| 2 1/2E | BRONZE | 415296-041 | |
| 3E | CAST IRON | 416179-011 | |
| 3E | BRONZE | 416179-041 | |
| 4E | CAST IRON | 415300-011 | |
| 4E | BRONZE | 415300-041 | |
| 5E | CAST IRON | 415302-011 | |
| 5E | BRONZE | 415302-041 | |
| 6E | CAST IRON | 416187-011 | |
| 6E | BRONZE | 416187-041 | |

**MODEL 4285 "M" SIZE
CLOSE COUPLED / MOTOR MOUNTED
PUMP PARTS**

1 1/4" IMPELLER BORE---PACKING GLAND 1 5/8" O.D. SHAFT SLEEVE
"OLD STYLE TANGENTIAL"

ITEM 102 IMPELLER 1 1/4" BORE**

| PUMP SIZE | MATERIAL | IMP. BORE | MAX. DIA. | PART NUMBER | BAR CODE |
|-----------|-----------|-----------|-----------|-------------|----------|
| 2 1/2 D | BRONZE | 1 1/4" | 7" | 419232-041 | |
| 2 1/2 D | CAST IRON | 1 1/4" | 7" | 419232-011 | |
| 3 D | BRONZE | 1 1/4" | 7" | 419234-041 | |
| 3 D | CAST IRON | 1 1/4" | 7" | 419234-011 | |
| 4 D | BRONZE | 1 1/4" | 7" | 419236-041 | |
| 4 D | CAST IRON | 1 1/4" | 7" | 419236-011 | |

** Impeller Part Numbers are for full or maximum diameter Impellers. Always specify Pump Serial Number and where possible, measure and advise the diameter of the Impeller being replaced on these Pumps.

**MODEL 4285 "M" SIZE
CLOSE COUPLED / MOTOR MOUNTED
PUMP PARTS**

1 1/4" IMPELLER BORE---PACKING GLAND 1 5/8" O.D. SHAFT SLEEVE
"OLD STYLE TANGENTIAL"

ITEM 103 VOLUTE GASKET

| PUMP SIZE | CONST. | PART NUMBER | BAR CODE |
|--------------|--------|-------------|----------|
| 1 1/2D TO 4D | ALL | 106592-000 | |
| 1 1/4E TO 6E | ALL | 406604-000 | |

ITEM 104 VOLUTE CAPSCREW

| PUMP SIZE | CONST. | NO. REQ'D | SIZE | PART NUMBER | BAR CODE |
|--------------|--------|-----------|------------------|-------------|----------|
| 1 1/2D TO 4D | ALL | 8 | 3/8-16NCX2 1/2" | 911121-120 | |
| 1 1/4E TO 6E | ALL | 12 | 7/16-14NCX1 1/4" | 911123-110 | |

ITEM 201 COVERPLATE

| PUMP SIZE | CONSTRUCTION | PART NUMBER | BAR CODE |
|--------------|--------------|-------------|----------|
| 1 1/4D TO 4D | B.F. & A.I.* | 419592-011 | |
| 1 1/4D TO 4D | A.B.* | 419592-041 | |
| 1 1/4E TO 6E | B.F. & A.I.* | 419593-011 | |
| 1 1/4E TO 6E | A.B.* | 419593-041 | |

NOTES:

- * B.F. Denotes "Bronze Fitted " construction. Parts in contact with pumped liquid are bronze or copper, except volute and cover plate.
- A.I. Denotes "All Iron " construction. Parts in contact with the pumped liquid are cast iron or steel, except shaft sleeve & mechanical seal.
- A.B. Denotes "All Bronze" construction. Parts in contact with the pumped liquid are bronze or stainless steel.

**MODEL 4285 "M" SIZE
CLOSE COUPLED / MOTOR MOUNTED
PUMP PARTS**

1 1/4" IMPELLER BORE---PACKING GLAND 1 5/8" O.D. SHAFT SLEEVE
"OLD STYLE TANGENTIAL"

| ITEM 206 MOTOR/PUMP BRACKET | | | | |
|------------------------------------|-------------------------|---------------|--------------------|-----------------|
| PUMP SIZE | MOTOR FRAME SIZE | CONST. | PART NUMBER | BAR CODE |
| 2 1/2D-6E | 284UC - 286UC | ALL | 425075-011 | |
| | 254JP - 256JP | | | |
| | 254 TCZ - 286 TCZ | | | |
| 2 1/2D-6E | 324UC TO 405UC | ALL | 425076-011 | |
| | 284JP TO 326JP | | | |
| | 254 TCZ TO 286 TCZ | | | |

| ITEM 207 M/P BRACKETCAPSCREW | | | | |
|-------------------------------------|-------------------------|---------------|--------------------|-----------------|
| PUMP SIZE | MOTOR FRAME SIZE | CONST. | PART NUMBER | BAR CODE |
| 2 1/2D-6E | 284UC - 286UC | ALL | 4 REQ'D | |
| | 254JP - 256JP | | 911123-110 | |
| | 254 TCZ - 286 TCZ | | 1/2-13NCX1 1/4" | |
| 2 1/2D-6E | 324UC TO 405UC | ALL | 4 REQ'D | |
| | 284JP TO 326JP | | 911129-110 | |
| | 254 TCZ TO 286 TCZ | | 5/8-11NCX1 1/4" | |

**MODEL 4285 "M" SIZE
CLOSE COUPLED / MOTOR MOUNTED
PUMP PARTS**

1 1/4" IMPELLER BORE---PACKING GLAND 1 5/8" O.D. SHAFT SLEEVE
"OLD STYLE TANGENTIAL"

ITEM 225 M/P BRKT. LOCKWASHER

| PUMP SIZE | MOTOR FRAME SIZE | CONST. | NO. REQ'D | SIZE | PART NUMBER | BAR CODE |
|--------------|---------------------|--------|--------------|------|----------------|----------|
| 2 1/2D-6E | 284UC - 286UC | ALL | 4 | 1/2" | 927213-100 | |
| | 254JP - 256JP | | | | | |
| | 254 TCZ - 286 TCZ | | | | | |
| 2 1/2D-6E | 324UC - 405UC | ALL | 4 | 5'8" | 927215-100 | |
| | 284JP - 326JP | | | | | |
| | 254 TCZ - 286 TCZ | | | | | |

ITEM 202 COVERPLATE CAPSCREW

| PUMP SIZE | CONST. | NO. REQ'D | SIZE | PART NUMBER | BAR CODE |
|--------------|--------|--------------|--------------|----------------|----------|
| ALL | ALL | 8 | 3/8"-16NCX1" | 911121-108 | |

MODEL 4285 "M" SIZE CLOSE COUPLED / MOTOR MOUNTED PUMP PARTS

1 1/4" IMPELLER BORE---PACKING GLAND 1 5/8" O.D. SHAFT SLEEVE
"OLD STYLE TANGENTIAL"

| ITEM 339 SHAFT SLEEVE | | | | |
|---|----------------|--------------|----------------|----------|
| MOTOR FRAME SIZE | SLEEVE O.D. | CONSTRUCTION | PART NUMBER | BAR CODE |
| 213JP TO 286JP 324 - 326JP 254 TCZ TO 286 TCZ | 1 5/8" | BF-AB | 425869-023 | |
| 213JP TO 286JP 324 - 326JP 254 TCZ TO 286 TCZ | 1 5/8" | AI | 425869-024 | |

| SHAFT SLEEVE SPACER | | | | |
|---|----------------|--------------|----------------|----------|
| MOTOR FRAME SIZE | SLEEVE O.D. | CONSTRUCTION | PART NUMBER | BAR CODE |
| 213JP TO 286JP 324 - 326JP 254 TCZ TO 286 TCZ | 1 5/8" | BF-AB-AI | 425868-002 | |

| SHAFT SLEEVE & SPACER KITS | | | | |
|---|----------------|--------------|----------------|----------|
| MOTOR FRAME SIZE | SLEEVE O.D. | CONSTRUCTION | PART NUMBER | BAR CODE |
| 213JP TO 286JP 324 - 326JP 254 TCZ TO 286 TCZ | 1 5/8" | BF-AB | 835085-007 | |
| 213JP TO 286JP 324 - 326JP 254 TCZ TO 286 TCZ | 1 5/8" | AI | 835085-008 | |

NOTES:

* B.F. Denotes "Bronze Fitted " construction. Parts in contact with pumped liquid are bronze or copper, except volute and cover plate.

A.I. Denotes "All Iron" construction. Parts in contact with the pumped liquid are cast iron or steel, except shaft sleeve & mechanical seal.

A.B. Denotes "All Bronze" construction. Parts in contact with the pumped liquid are bronze or stainless steel.

MODEL 4285 "M" SIZE CLOSE COUPLED / MOTOR MOUNTED PUMP PARTS

1 1/4" IMPELLER BORE---PACKING GLAND 1 5/8" O.D. SHAFT SLEEVE
"OLD STYLE TANGENTIAL"

| COMMON PARTS | | | |
|------------------------|---|------------------------|-----------------|
| ITEM NUMBER | DESCRIPTION | PART NUMBER | BAR CODE |
| 117 | IMPELLER CAPSCREW S/S | 911900-113 | |
| 118 | IMPELLER WASHER B.F./A.I./A.B.* | 425742-003 | |
| 216 | GLAND PACKING (5 RINGS REQ'D) | 966301-007 | |
| 217 | LANTERN RING B.F. & A.B.* | 419596-041 | |
| 217 | LANTERN RING A.I.* | 419596-011 | |
| 218 | GLAND B.F. & A.B.* | 419595-041 | |
| 218 | GLAND A.I.* | 419595-011 | |
| 219 | GLAND STUD (2 REQ'D) 3/8"NCX2 3/8"S/S | 915221-420 | |
| 220 | GLAND NUT (2 REQ'D) 3/8"NC S/S | 913121-400 | |
| 222 | GLAND CLAMP | 419490-071 | |
| 340 | IMPELLER KEY 1/4" SQ. X 1 3/4" LG. | 428161-114 | |
| 342 | WATER SLINGER | 411343-000 | |

NOTES:

* B.F. Denotes "Bronze Fitted " construction. Parts in contact with pumped liquid are bronze or copper, except volute and cover plate.

A.I. Denotes "All Iron" construction. Parts in contact with the pumped liquid are cast iron or steel, except shaft sleeve & mechanical seal.

A.B. Denotes "All Bronze" construction. Parts in contact with the pumped liquid are bronze or stainless steel.