

ARMSTRONG

PARTS LIST

SERIES 4285

"CLOSE COUPLED"

OR

MOTOR MOUNTED PUMP

PACKING GLAND DESIGN

TANGENTIAL DISCHARGE

"S" DESIGNATION

7/8" IMPELLER BORE--1 1/4" SHAFT SLEEVE

4285 POWER FRAMES, ALL SPEEDS, SIZE DESIGNATION

SPEED		MOTOR HP											
1800RPM		1/2,3/4&1	1 1/2&2	3	5	7 1/2	10	15	20	25	30	40	50
3600RPM		1 1/2	2&3	5	7 1/2	10	15	20	25	30	40	50	60
FRAME SIZE	1954 RERATE	182C	184C	213C	215C	254UC	256UC	284UC	286UC	324UC	326SC		
	WEST COAST	182YCZ	184YCZ	213CZ	215CZ	254UCZ	256UCZ	254UCZ	256UCZ	284UCZ	286UCZ	324UCZ	326UCZ
	1972 RERATE	143JP	145JP	182JP	184JP	213JP	215JP	254JP	256JP	284JP	286JP	324JP	326JP
PUMP SIZE													
	1 1/4D	S	S	S	S	M	-	-	-	-	-	-	-
	1 1/2D	S	S	S	S	M	M	-	-	-	-	-	-
	2D	S	S	S	S	M	M	-	-	-	-	-	-
	2 1/2D	S	S	S	S	M	M	M	-	-	-	-	-
	3D	S	S	S	-	M	M	M	M	-	-	-	-
	4D	-	S	S	S	-	M	M	M	M	M	-	-
	1 1/4E	-	S	S	S	-	M	M	M	M	-	-	-
	1 1/2E	-	S	S	S	-	M	M	M	M	M	-	-
	2E	-	S	S	S	M	-	M	M	M	M	M	-
	2 1/2E	-	-	S	S	M	-	-	-	-	-	-	-
	3E	-	-	S	S	M	-	-	-	-	-	-	-
	4E	-	-	S	S	M	M	M	-	-	-	-	-
	5E	-	-	S	S	M	M	M	M	-	-	-	-
	6E	-	-	-	-	-		M	M	M	-	-	-

"S" DESIGNATION - 7/8" IMPELLER BORE, 1 1/4" I.D. PACKING

"M" DESIGNATION - 1 1/4" IMPELLER BORE, 1 5/8" I.D. PACKING

CLOSE COUPLED / MOTOR MOUNTED

OLD STYLE TANGENTIAL, PACKING GLAND DESIGN

MODEL 4285 "S" DESIGNATION

SECTIONAL DRAWING

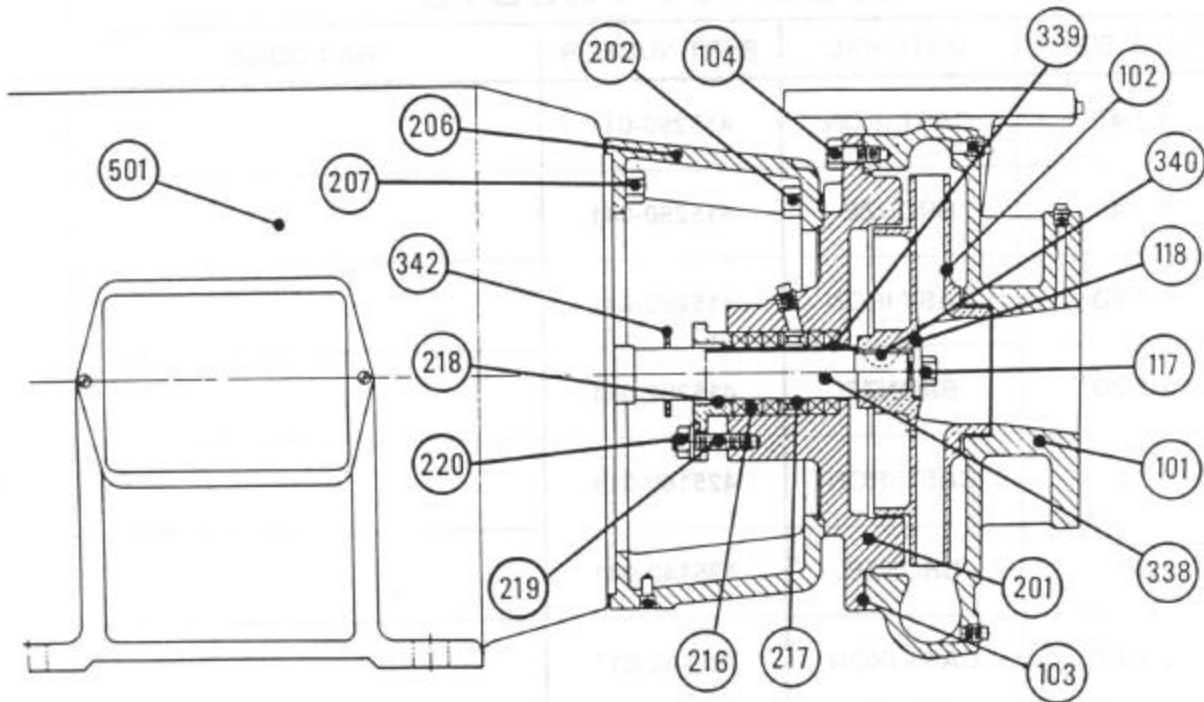

ITEM NO.	DESCRIPTION	PAGE NO.	ITEM NO.	DESCRIPTION	PAGE NO.
101	VOLUTE	3 & 4	217	LANTERN RING	10
102	IMPELLER	5 & 6	218	GLAND	10
103	VOLUTE GASKET	7	219	GLAND STUD	10
104	VOLUTE CAPSCREW	7	220	GLAND STUD NUT	10
117	IMPELLER CAPSCREW	10	222	GLAND CLAMP	10
118	IMPELLER WASHER	10	225	MOTOR CAPSCREW LOCKWASHER	8
201	COVERPLATE	7	339	SHAFT SLEEVE	9
202	COVERPLATE CAPSCREW	8	340	IMPELLER KEY	10
206	MOTOR/PUMP BRACKET	8	342	WATER SLINGER	10
207	MOTOR CAPSCREW	8	not shown	SHAFT SLEEVE SPACER	9
216	GLAND PACKING	10	not shown	SHAFT SLEEVE & SPACER KITS	9

MODEL 4285 "S" SIZE

CLOSE COUPLED / MOTOR MOUNTED

PUMP PARTS

7/8" IMPELLER BORE---PACKING GLAND 1 1/4" O.D. SHAFT SLEEVE

"OLD STYLE TANGENTIAL"

ITEM 101 VOLUTE			
PUMP SIZE	MATERIAL	PART NUMBER	BAR CODE
1 1/4D	CAST IRON	415290-011	
1 1/4D	BRONZE	415290-041	
1 1/2D	CAST IRON	415292-011	
1 1/2D	BRONZE	415292-041	
2D	CAST IRON	425140-011	
2D	BRONZE	425140-041	
2 1/2D	CAST IRON	425142-011	
2 1/2D	BRONZE	425142-041	
3D	CAST IRON	425144-011	
3D	BRONZE	425144-041	
4D	CAST IRON	415298-011	
4D	BRONZE	415298-041	

MODEL 4285 "S" SIZE

CLOSE COUPLED / MOTOR MOUNTED

PUMP PARTS

7/8" IMPELLER BORE---PACKING GLAND 1 1/4" O.D. SHAFT SLEEVE

"OLD STYLE TANGENTIAL"

ITEM 101 VOLUTE (CONT'D)

PUMP SIZE	MATERIAL	PART NUMBER	BAR CODE
1 1/4E	CAST IRON	416167-011	
1 1/4E	BRONZE	416167-041	
1 1/2E	CAST IRON	425146-011	
1 1/2E	BRONZE	425146-041	
2E	CAST IRON	419152-011	
2E	BRONZE	419152-041	
2 1/2E	CAST IRON	415296-011	
2 1/2E	BRONZE	415296-041	
3E	CAST IRON	416179-011	
3E	BRONZE	416179-041	
4E	CAST IRON	415300-011	
4E	BRONZE	415300-041	
5E	CAST IRON	415302-011	
5E	BRONZE	415302-041	

MODEL 4285 "S" SIZE CLOSE COUPLED / MOTOR MOUNTED PUMP PARTS

7/8" IMPELLER BORE---PACKING GLAND 1 1/4" O.D. SHAFT SLEEVE

"OLD STYLE TANGENTIAL"

ITEM 102 IMPELLER** 7/8" BORE

PUMP SIZE	MATERIAL	IMP. BORE	MAX. DIA.	PART NUMBER	BAR CODE
1 1/4 D	BRONZE	7/8"	7"	411852-041	
1 1/4 D	CAST IRON	7/8"	7"	411852-011	
1 1/2 D	BRONZE	7/8"	7"	411860-041	
1 1/2 D	CAST IRON	7/8"	7"	411860-011	
2 D	BRONZE	7/8"	7"	411860-041	
2 D	CAST IRON	7/8"	7"	411860-011	
2 1/2 D	BRONZE	7/8"	7"	406642-041	
2 1/2 D	CAST IRON	7/8"	7"	406642-011	
3 D	BRONZE	7/8"	7"	411868-041	
3 D	CAST IRON	7/8"	7"	411868-011	
4 D	BRONZE	7/8"	7"	411874-041	
4 D	CAST IRON	7/8"	7"	411874-041	

** Impeller Part Numbers are for full or maximum diameter Impellers. Always specify Pump Serial Number and where possible, measure and advise the diameter of the Impeller being replaced on these Pumps.

MODEL 4285 "S" SIZE CLOSE COUPLED / MOTOR MOUNTED PUMP PARTS

7/8" IMPELLER BORE---PACKING GLAND 1 1/4" O.D. SHAFT SLEEVE
"OLD STYLE TANGENTIAL"

ITEM 102 IMPELLER** 7/8" BORE (cont'd)

PUMP SIZE	MATERIAL	IMP. BORE	MAX. DIA.	PART NUMBER	BAR CODE
1 1/4 E	BRONZE	7/8"	9 1/2"	407922-041	
1 1/4 E	CAST IRON	7/8"	9 1/2"	407922-011	
1 1/2 E	BRONZE	7/8"	9 1/2"	407922-041	
1 1/2 E	CAST IRON	7/8"	9 1/2"	407922-011	
2 E	BRONZE	7/8"	9 1/2"	411881-041	
2 E	CAST IRON	7/8"	9 1/2"	411881-011	
2 1/2 E	BRONZE	7/8"	9 1/2"	411881-041	
2 1/2 E	CAST IRON	7/8"	9 1/2"	411881-011	
3 E	BRONZE	7/8"	9 1/2"	419465-041	
3 E	CAST IRON	7/8"	9 1/2"	419465-011	
4 E	BRONZE	7/8"	9 1/2"	411940-041	
4 E	CAST IRON	7/8"	9 1/2"	411940-011	
5 E	BRONZE	7/8"	9 1/2"	411941-041	
5 E	CAST IRON	7/8"	9 1/2"	411941-011	

** Impeller Part Numbers are for full or maximum diameter Impellers. Always specify Pump Serial Number and where possible, measure and advise the diameter of the Impeller being replaced on these Pumps.

MODEL 4285 "S" SIZE CLOSE COUPLED / MOTOR MOUNTED PUMP PARTS

7/8" IMPELLER BORE---PACKING GLAND 1 1/4" O.D. SHAFT SLEEVE
"OLD STYLE TANGENTIAL "

ITEM 201 COVERPLATE			
PUMP SIZE	CONST.	PART NUMBER	BAR CODE
1 1/4D TO 4D	B.F. & A.I.*	419457-011	
1 1/4D TO 4D	A.B.*	419457-041	
1 1/4E TO 5E	B.F. & A.I.*	419459-011	
1 1/4E TO 5E	A.B.*	419459-041	

ITEM 103 VOLUTE GASKET			
PUMP SIZE	CONST.	PART NUMBER	BAR CODE
1 1/4D TO 4D	ALL	106592-000	
1 1/4E TO 5E	ALL	406604-000	

ITEM 104 VOLUTE CAPSCREW					
PUMP SIZE	CONST.	NO. REQ'D	SIZE	PART NUMBER	BAR CODE
1 1/4D TO 4D	ALL	8	3/8-16NCX1"	911121-108	
1 1/4E TO 5E	ALL	12	7/16-14NCX1"	911123-108	

NOTES:

* B.F. Denotes "Bronze Fitted " construction. Parts in contact with pumped liquid are bronze or copper, except volute and cover plate

A.I. Denotes "All Iron " construction. Parts in contact with the pumped liquid are cast iron or steel, except shaft sleeve & mechanic

A.B. Denotes "All Bronze" construction. Parts in contact with the pumped liquid are bronze or stainless steel.

**MODEL 4285 "S" SIZE
CLOSE COUPLED / MOTOR MOUNTED
PUMP PARTS**

7/8" IMPELLER BORE---PACKING GLAND 1 1/4" O.D. SHAFT SLEEVE
"OLD STYLE TANGENTIAL"

ITEM 202 COVERPLATE CAPSCREW

PUMP SIZE	FRAME SIZE	CONST.	NO. REQ'D	SIZE	PART NUMBER	BAR CODE
ALL	ALL	ALL	8	3/8-16NCX1 1/4"	911121-110	

ITEM 206 MOTOR/PUMP BRACKET

PUMP SIZE	FRAME SIZE	CONST.	PART NUMBER	BAR CODE
1 1/4D-5E	182C-184C 143JP-145JP 213C-254UC 215C-256UC 213JP-215JP	ALL	425074-011	

ITEM 207 MOTOR CAPSCREW

PUMP SIZE	FRAME SIZE	CONST.	NO. REQ'D	SIZE	PART NUMBER	BAR CODE
1 1/4D-5E	182C-184C 143JP-145JP 213C-254UC 215C-256UC 213JP-215JP	ALL	4	1/2-13NCX1 1/4"	911123-110	

ITEM 225 MOTOR CAPS. LOCKWASHER

PUMP SIZE	FRAME SIZE	CONST.	NO. REQ'D	SIZE	PART NUMBER	BAR CODE
1 1/4D-5E	182C-184C 143JP-145JP 213C-254UC 215C-256UC 213JP-215JP	ALL	4	1/2"	927213-100	

**MODEL 4285 "S" SIZE
CLOSE COUPLED / MOTOR MOUNTED
PUMP PARTS**

7/8" IMPELLER BORE---PACKING GLAND 1 1/4" O.D. SHAFT SLEEVE
"OLD STYLE TANGENTIAL"

ITEM 339 SHAFT SLEEVE

MOTOR FRAME SIZE	SLEEVE O.D.	CONSTRUCTION	PART NUMBER	BAR CODE
182CZ TO 256UCZ 143JP TO 184JP	1 1/4"	BF-AB	425869-013	
182C TO 256UC 143JP TO 184JP	1 1/4"	AI	425869-014	

SHAFT SLEEVE SPACER

MOTOR FRAME SIZE	SLEAVE O.D.	CONSTRUCTION	PART NUMBER	BAR CODE
182C TO 256UC 143JP TO 184JP	1 1/4"	BF-AB-AI	425868-001	

SHAFT SLEEVE & SPACER KITS

MOTOR FRAME SIZE	SLEEVE O.D.	CONSTRUCTION	PART NUMBER	BAR CODE
182CZ TO 256UCZ 143JP TO 184JP	1 1/4"	BF-AB	835085-003	
182C TO 256UC 143JP TO 184JP	1 1/4"	AI	835085-004	

MODEL 4285 "S" SIZE CLOSE COUPLED / MOTOR MOUNTED PUMP PARTS

7/8" IMPELLER BORE---PACKING GLAND 1 1/4" O.D. SHAFT SLEEVE
"OLD STYLE TANGENTIAL "

COMMON PARTS

ITEM NUMBER	DESCRIPTION	PART NUMBER	BAR CODE
117	IMPELLER CAPSCREW S/S	911900-108	
118	IMPELLER WASHER B.F.& A.I.*	406614-000	
118	IMPELLER WASHER A.B.*	406677-000	
216	GLAND PACKING SET(5 RINGS)	966301-002	
217	LANTERN RING B.F. & A.B.	419461-041	
217	LANTERN RING A.I.	419461-011	
218	GLAND B.F. & A.B.	419463-041	
218	GLAND A.I.	419463-011	
219	GLAND STUD (2 REQ'D)	915221-420	
220	GLAND NUT (2 REQ'D) 3/8"NC	913121-400	
222	GLAND CLAMP	419490-071	
340	IMPELLER KEY 3/16" SQ. X 1 1/4" LG	428160-010	
342	WATER SLINGER	406622-000	

NOTES:

* B.F. Denotes "Bronze Fitted " construction. Parts in contact with pumped liquid are bronze or copper, except volute and cover plate.

A.I. Denotes "All Iron" construction. Parts in contact with the pumped liquid are cast iron or steel, except shaft sleeve & mechanical seal.

A.B. Denotes "All Bronze" construction. Parts in contact with the pumped liquid are bronze or stainless steel.